

※請仔細閱讀此說明書，以確保您可以在最短時間內完成安裝。
Please read this instruction carefully to ensure the installation is completed.

NDST-E

安裝說明書 --- Installation Introduction

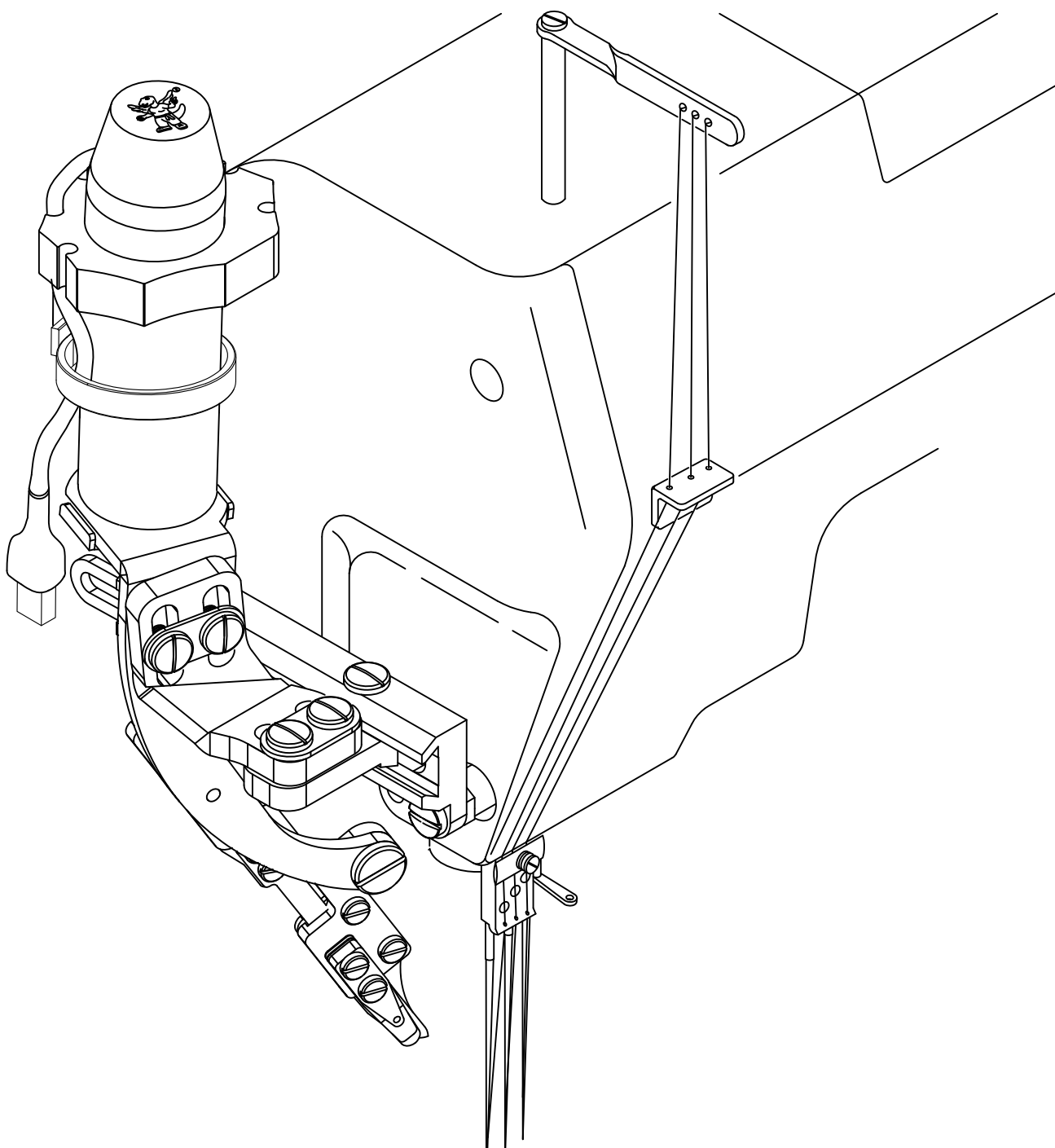

2015.04 / Ver. 1.3

前言 PREFACE:

- 請依本說明書頁次逐項安裝與調整，以確保您可以在最短時間內得到最佳運轉效果。
- Please follow this operation instruction to install & adjust step by step You will get the best efficiency in the short time.

(一) 安裝上刀切線裝置NDST-E
Installation of the upper thread trimmer device.

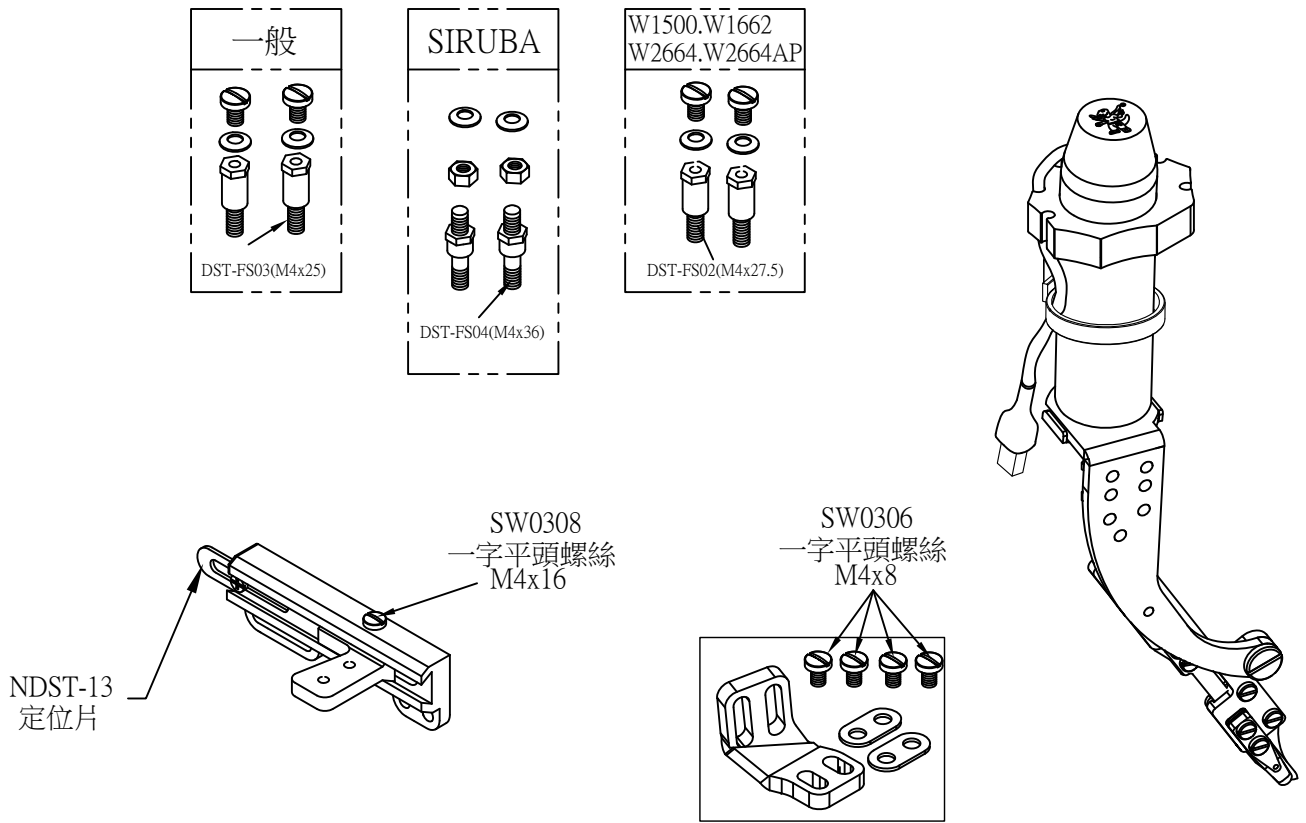

(二) DST-2P 或 DST-4P 電線組安裝圖
Installation diagram for DST-2P or DST-4P

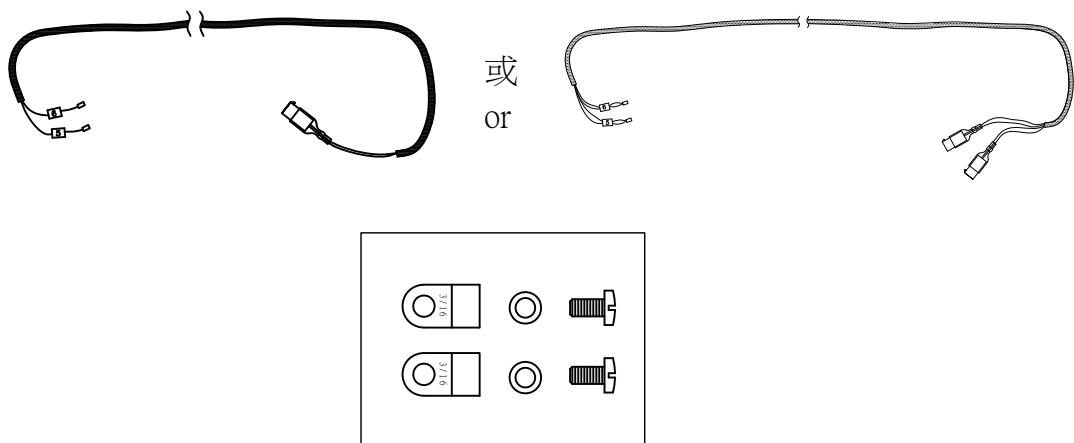

(一) 安裝上刀切線裝置NDST-E (Installation of the upper thread trimmer)

● 包裝盒內位置標示 The position in the box

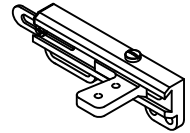
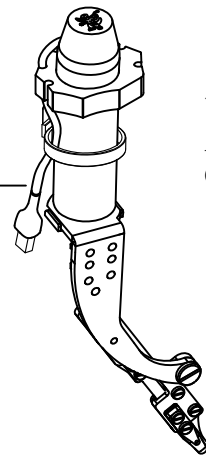
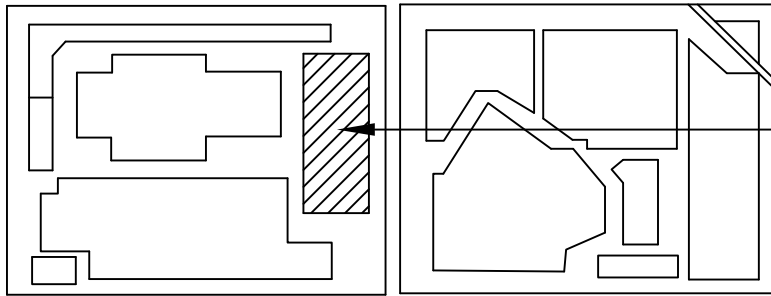

依購買機種所附給
Attached tool bag depends
on suitable model.

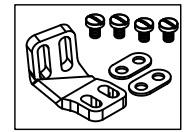
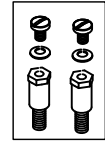

● 安裝位置示意圖 Installation diagram chart.

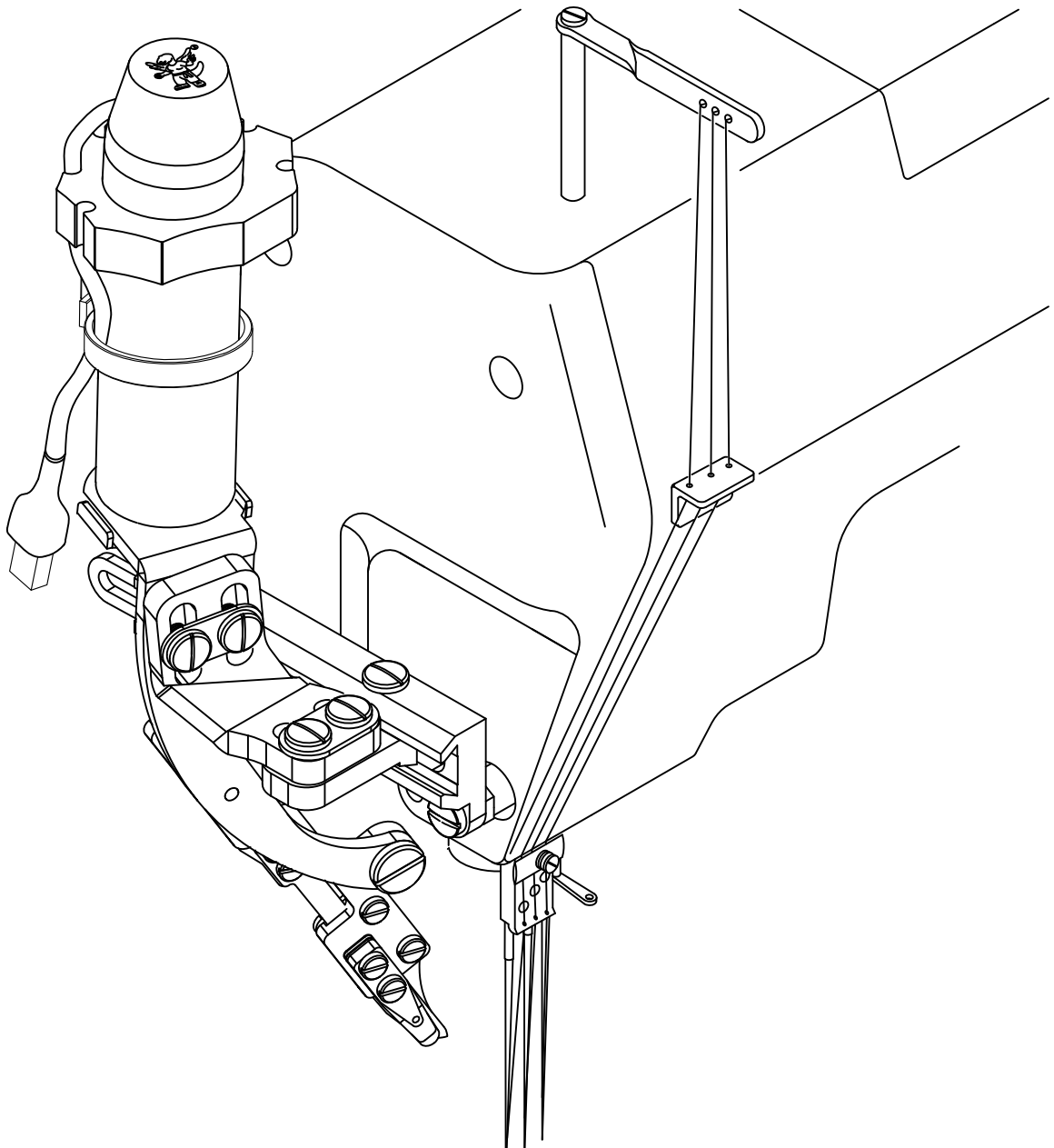

※請依下列步驟安裝。 Please follow the installation step.

- (A) 將手輪轉至P點。
Rotate the handle wheel to
“P” position.

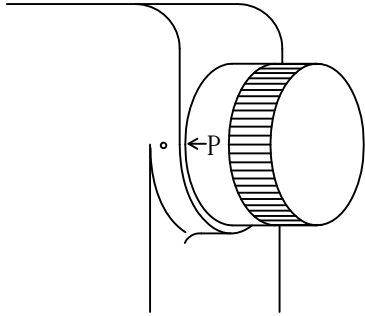

- (B) 裝上定位螺絲後安裝滑槽組。
Install the fixed screw and then the bracket.

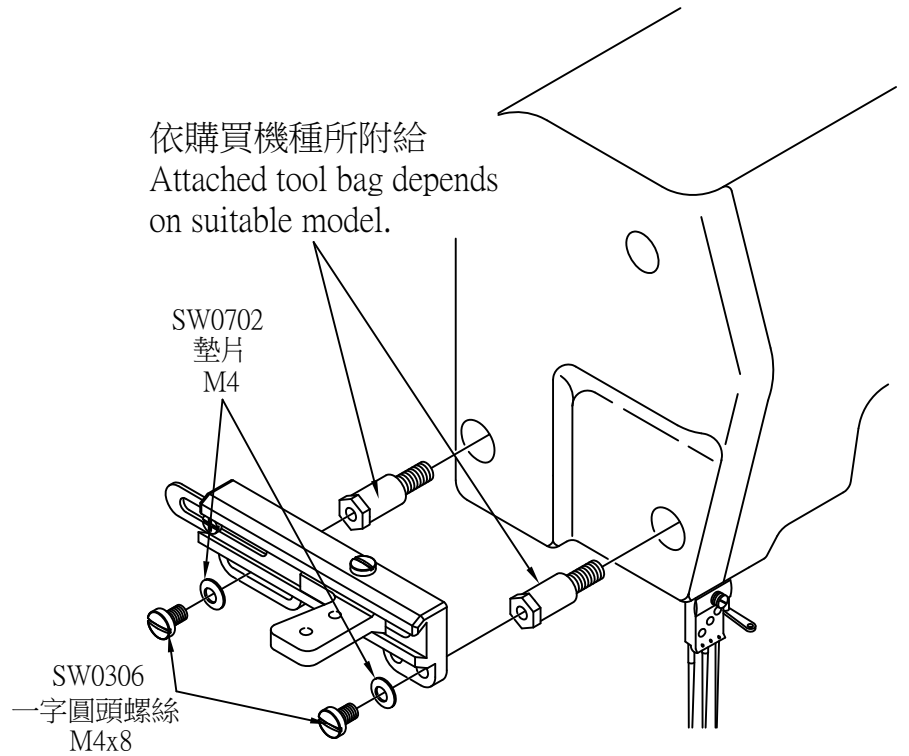

- (C) 安裝切線組。
Install the Trimmer device.

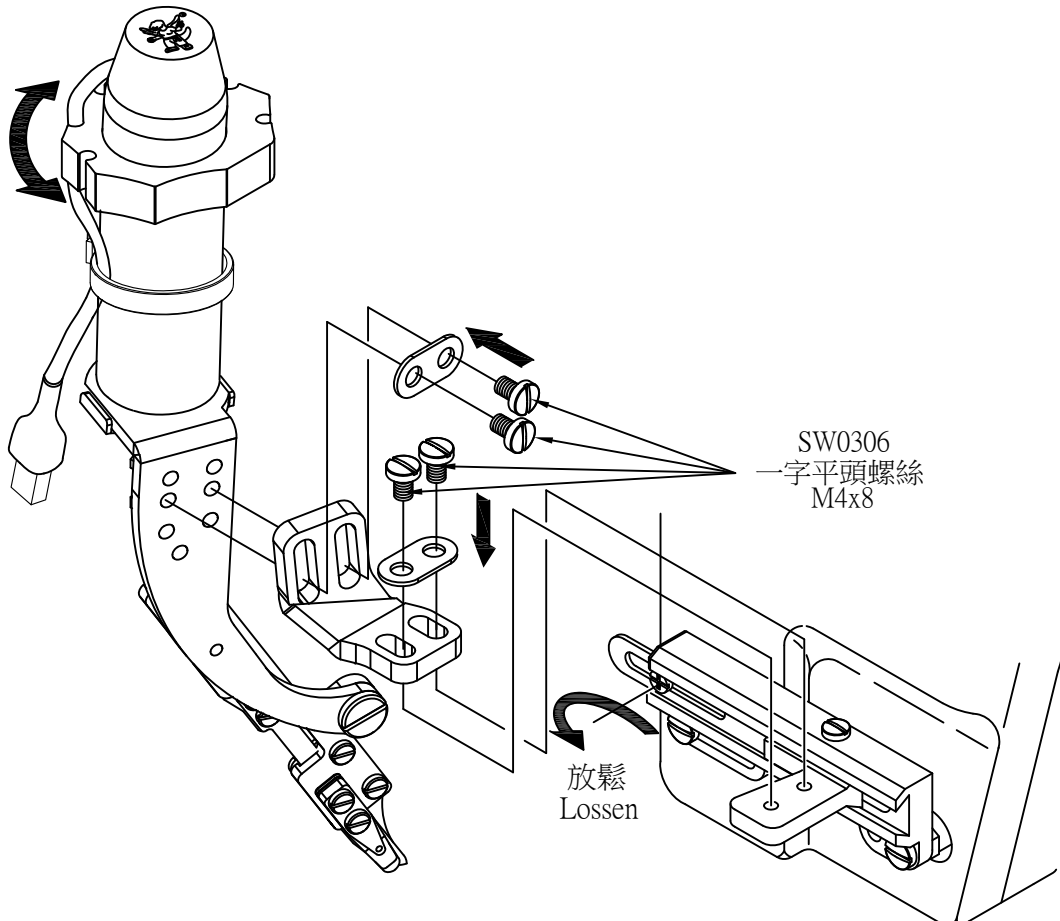

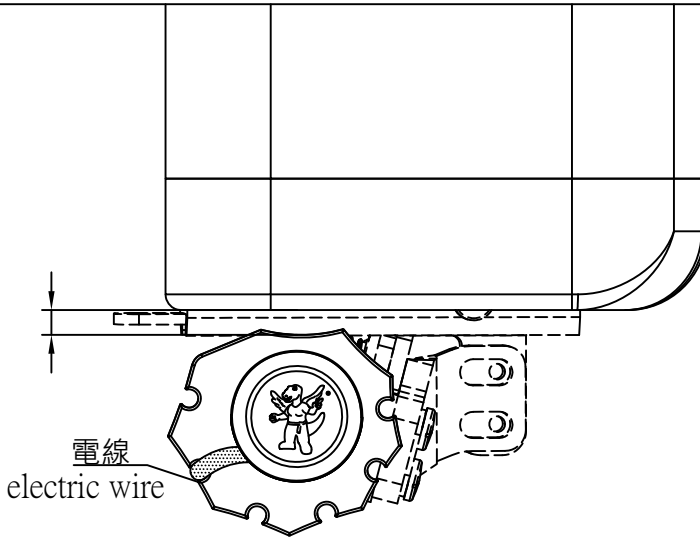

※當套上電磁鐵之橡膠墊片,正對齊機頭面時,以最小面為基準。

※ After device installed with solenoid rubber gaskets, the standard is minimum griding side when aligned with machine head

放鬆螺絲調整切線組左右位置與高度:

(D) (1)使彈片與上網針鉤尖之距離約4.5~5.5mm,並推出切線片,使切線片鉤尖與上網針鉤尖在水平線時左右距離為1mm.

(2)將切線片推到底時上網針下方與切線片刀嘴的上下距離約為0.5mm

(D) Adjust the left and right position and height of trimmer device by loosen the screw.

1. Make the distance between the reed and the spreader tip to 4.5-5.5mm. And then push out the knife to make the clearance between both tip of knife and spreader to 1mm when in parallel.
2. When the knife push to the end, make the clearance between below spreader and above knife tip to 0.5mm.

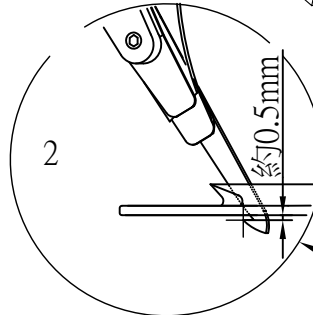
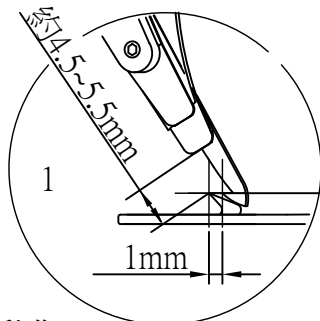
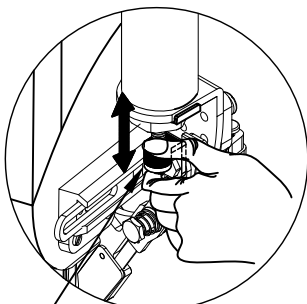
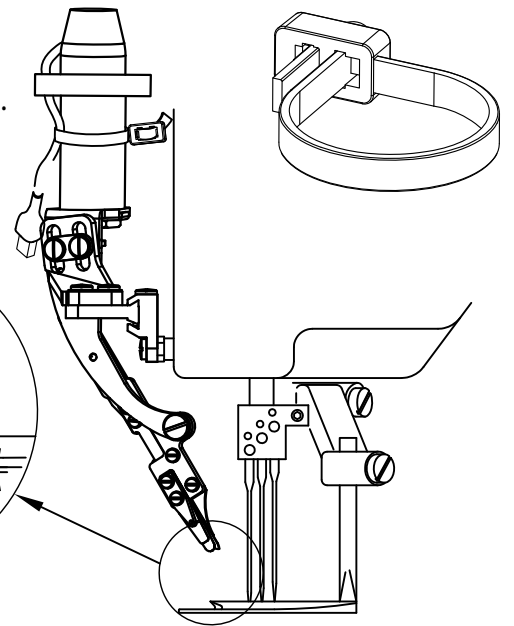

調整此處來完成校刀動作

Adjust here to correct the knife position

(E) 放鬆十字螺絲前後移動滑塊,使切線片與上網針之間距(如圖所示之位置)為0.1~0.3mm,且切線片與上網針並排時其角度需一致。

Loosen the screw and move the sliding piece forward and backward to make the distance between knife and spreader to 0.1-0.3mm as following figure. The angle should be the same between knife and spreader side by side.

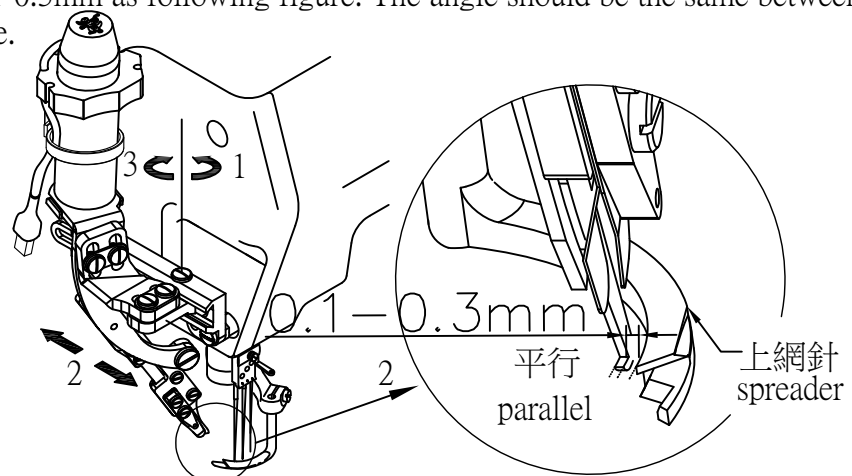

- (F) (1)將定位片靠緊滑塊。 The fixing slice should keep close to sliding piece.
 (2)鎖緊螺絲。 Fasten the scew.

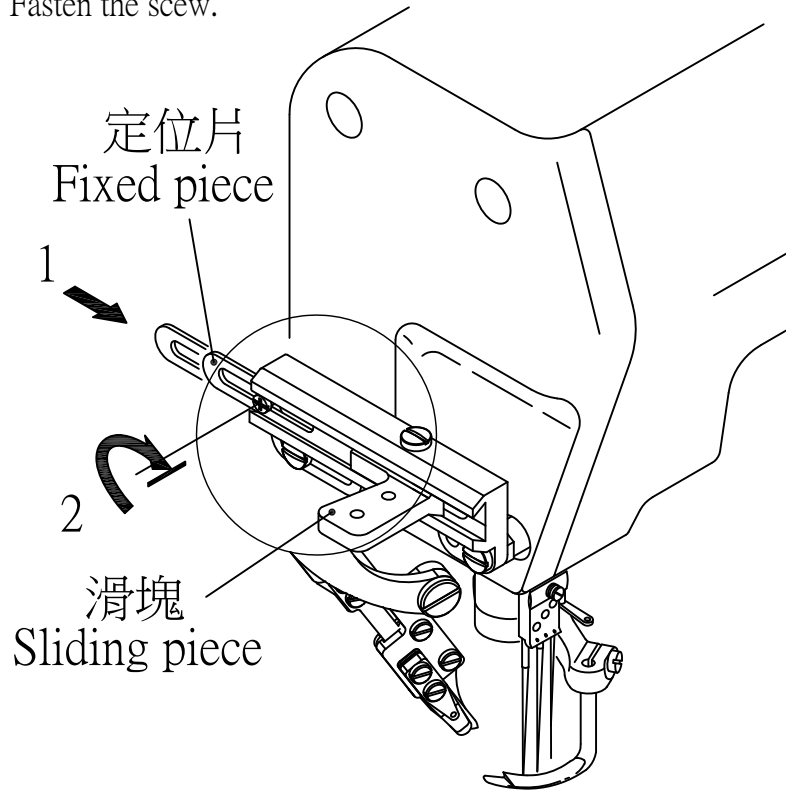

※安裝完畢後,定位片不再移動,只需放鬆指定螺絲即可快速拆換。

※After installation, do not need to move the fixing slice. Just loose the screw for take apart the trimmer swiftly.

- 1.放鬆螺絲(Loosen the screw)
- 2.取下切線組(Take off the NDST-E)
- 3.拆除上網針
(Dismantle the spreader)

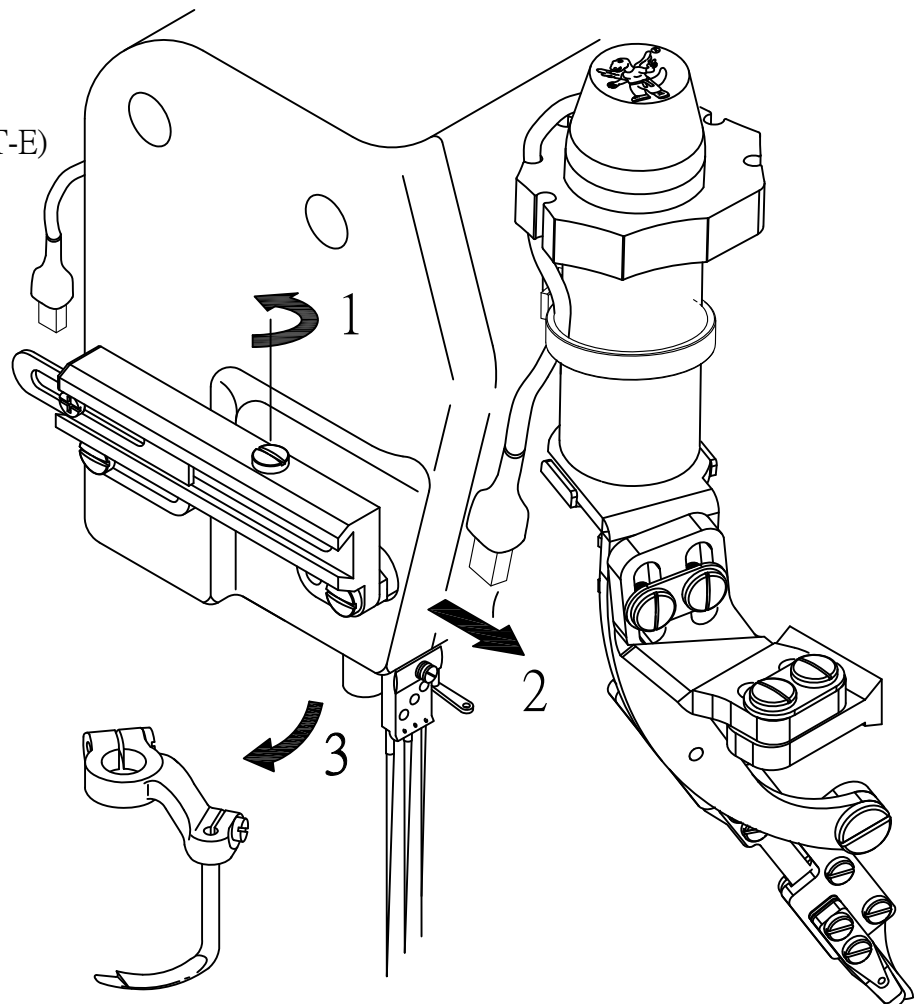

※裝回機構時,只需調整將切線片推出使切線片鉤尖與上網針鉤尖在水平線時左右距離為1mm
 When install back the device, only need to push out the knife to make the clearance between both tip of knife and spreader to 1mm when in parallel.

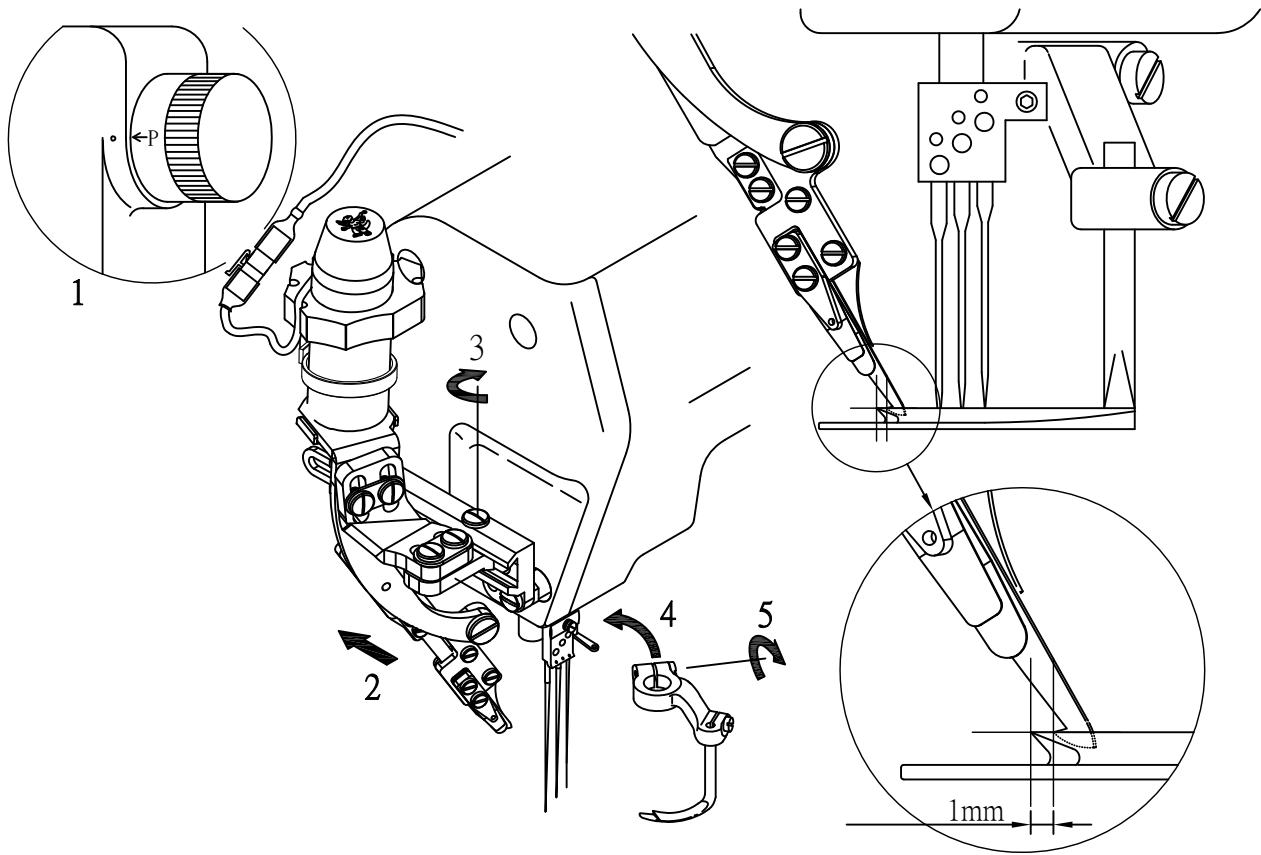

※調整橡膠墊片 Adjust the rubber washer

1. 起始橡膠墊片最小面與機頭無法貼齊時, 需調整至步驟2(如右圖)。

1. If the minimum side of the rubber is unable touch to the machine please adjust as step 2.

2. 向左迴轉後,橡膠與機頭面貼齊至適當位置即可。

2. Turn left the rubber until touch to the machine at the right position .

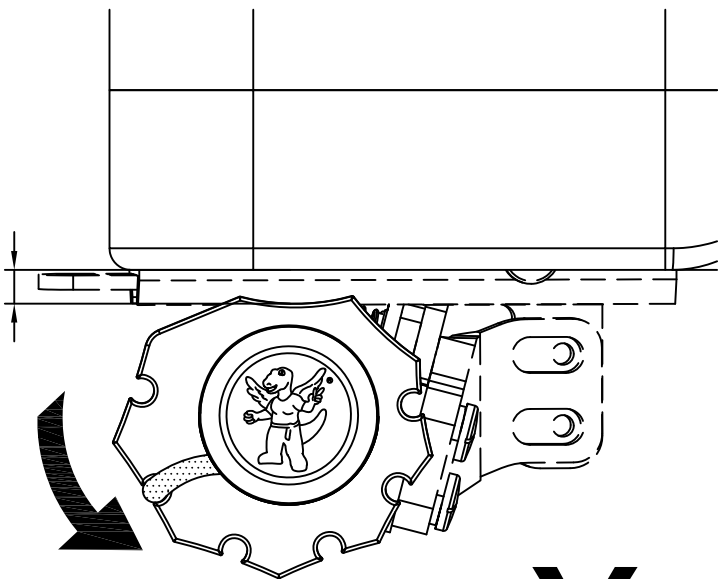

X

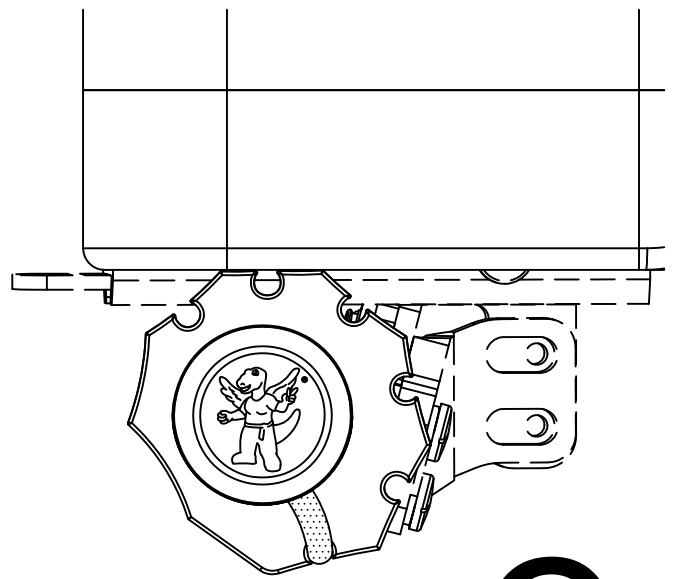

O

(二) DST-4P電線組安裝圖 Installation description for DST-4P

●包裝盒內位置標示 The position in the box

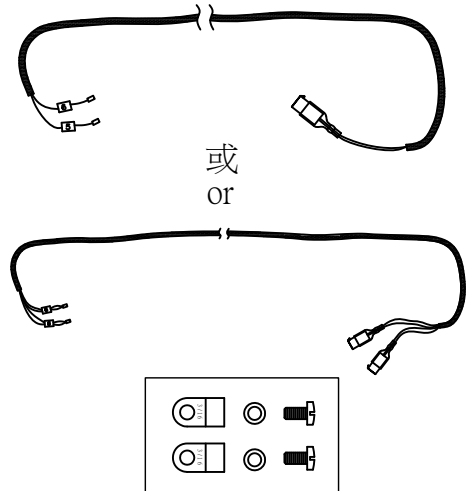
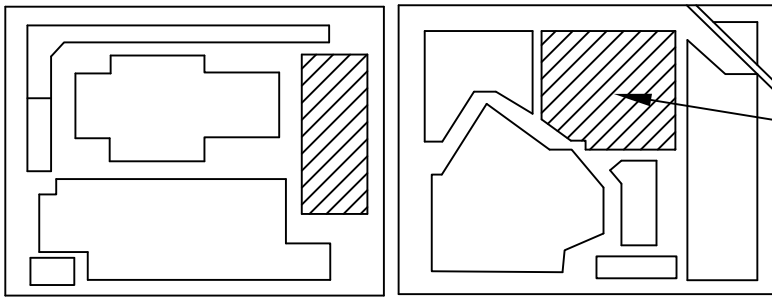

●安裝位置示意圖 Installation description chart.

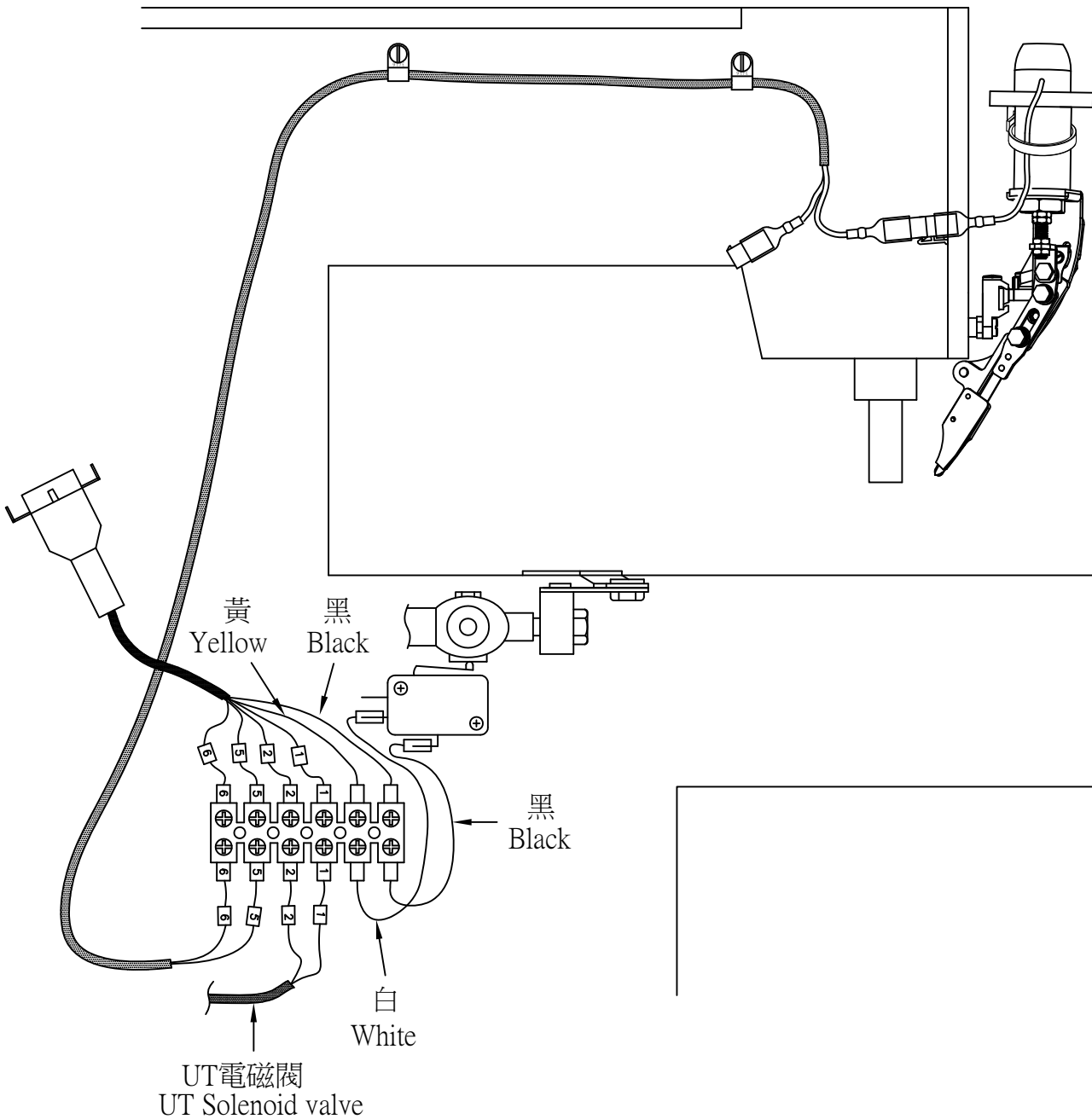

第二部 SECOND PART

零件分析圖表

COMPONENT ANALYSIS CHART

NDST-E 上刀切線裝置機構零件分析圖

NDST-E Upper thread trimmer

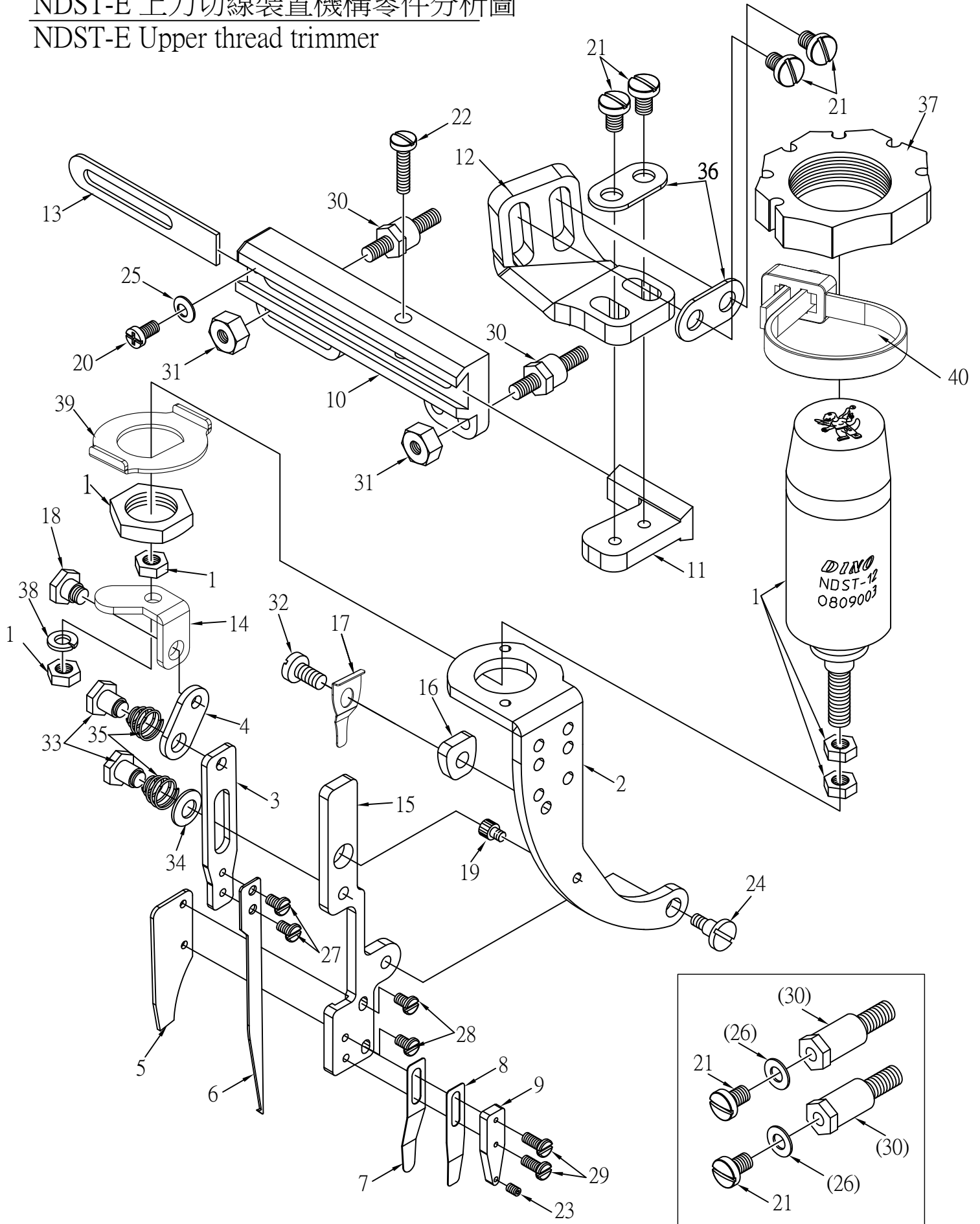

NDST-E 上刀切線裝置機構零件分析表

NDST-E Upper thread trimmer

序號 Ref.No.	物料編號 Part.No.	名稱 Description		單位用量 Amt.Req.
1	TWP-18-1	電磁鐵	Electromagnetic valve	1
2	NDST-01-1	本體	Main plate	1
3	NDST-03	驅動臂	Driving lever	1
4	NDST-04	擺臂	Swing Lever	1
5	DST-05	固定刀片	Fixed knife	1
6	DST-06	活動刀片	Movable knife	1
7	DST-07	下簧片	Lower reed	1
8	DST-08	上簧片	Upper reed	1
9	DST-09	簧片座	Reed bracket	1
10	DST-10	滑塊定位座	Sliding positioned bracket	1
11	DST-11	滑塊	Sliding piece	1
12	NDST-08	調整片	Adjusting piece	1
13	DST-13	定位片	Positioned piece	1
14	NDST-06	電動連接片	Connection slice for Electric	1
15	NDST-02	NDST主體	NDST main plate	1
16	NDST-07	墊高片	Heighten Slice	1
17	W664E-UT09-B	下刀調整簧片	Under trimmer adjusting reed	- 1
18	NDST-09	特製螺絲	Special Screw	1
19	SW0101	六角承窩螺絲	Hexagon socket screw	M3x3 1
20	SW1001	十字平頭螺絲	Crossed flat head screw	M3x6 1
21	SW0306	一字平頭螺絲	Flat head slot screw	M4x8 6
22	SW0308	一字平頭螺絲	Flat head slot screw	M4x16 1
23	SW0501	六角承窩螺絲	Hexagon socket screw	M2x3 1
24	NDST-10	特殊螺絲	Special Screw	1
25	SW0701	墊片	Washer	M3 1
26	SW0702	墊片	Washer	M4 2
27	SW0801	一字平頭螺絲	Flat head slot screw	3/32-SM56x2 2
28	SW0802	一字平頭螺絲	Flat head slot screw	3/32-SM56x4 2
29	SW0803	一字平頭螺絲	Flat head slot screw	3/32-SM56x5 2
30	參考下頁	車頭螺絲	Fixed screw	(Refer next page) 2
31	SW0602	六角螺帽	Hexagon nut	M4 2
32	SW0303	一字平頭螺絲	Flat heat slot screw	M4x5 1
33	NDST-14	特製螺絲	Special Screw	2
34	SW0703	墊片	Washer	M5 1
35	W5025	錐形彈簧	Spring	2
36	NDST-16	防滑片	Skidproof piece	2
37	NDST-17	橡膠	Rubber	1
38	SW0709	彈簧墊片	Spring washer	M4 1
39	TWP-22	墊片	Waving washer	1
40	RDCV225BK	可退式雙頭束帶	Resuable universal tie	1

NDST-E 車頭螺絲適用機型表

NDST-E Application list of fixed screw

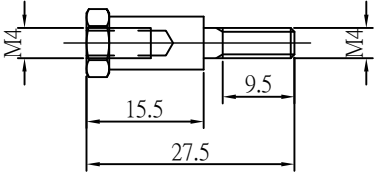
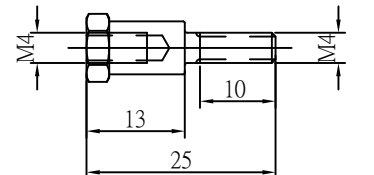
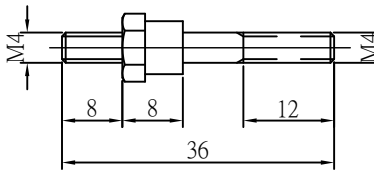
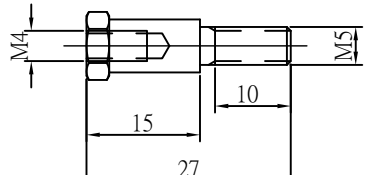
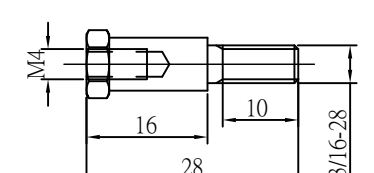
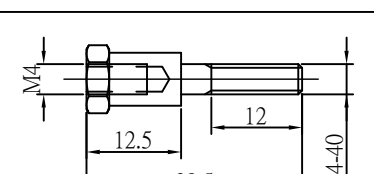
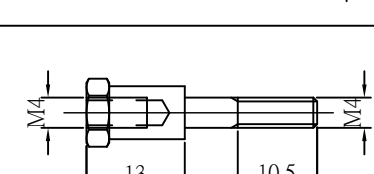
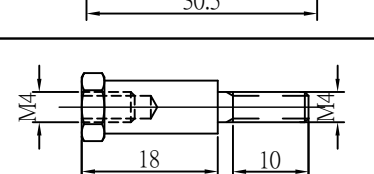
件號 REF.No.	零件圖號 Part.No.	規格 Spec.	適用機型 Application.
30	DST-FS02		W664.W500.W264
30	DST-FS03		VC2700.VF2500.FW-787 VG-888.VG2700.W1500 MF7723.MF7823.CSN1300 CSN1300H.SG787.SG797 CT9311.CT9085.CT6500 W1662,W2664/AP,CC2700
30	DST-FS04		C007E.C007H.F007H. C007EH.F007E.
30	DST-FS05		WX8803.RX9803.
30	DST-FS06		MFC7605U.MF7605U.
30	DST-FS07		FD3-252.FD4-272.
30	DST-FS08		K-CHANCE® : KC3-3700 VF3-3500
30	DST-FS10		ZJC2500

DST-4P

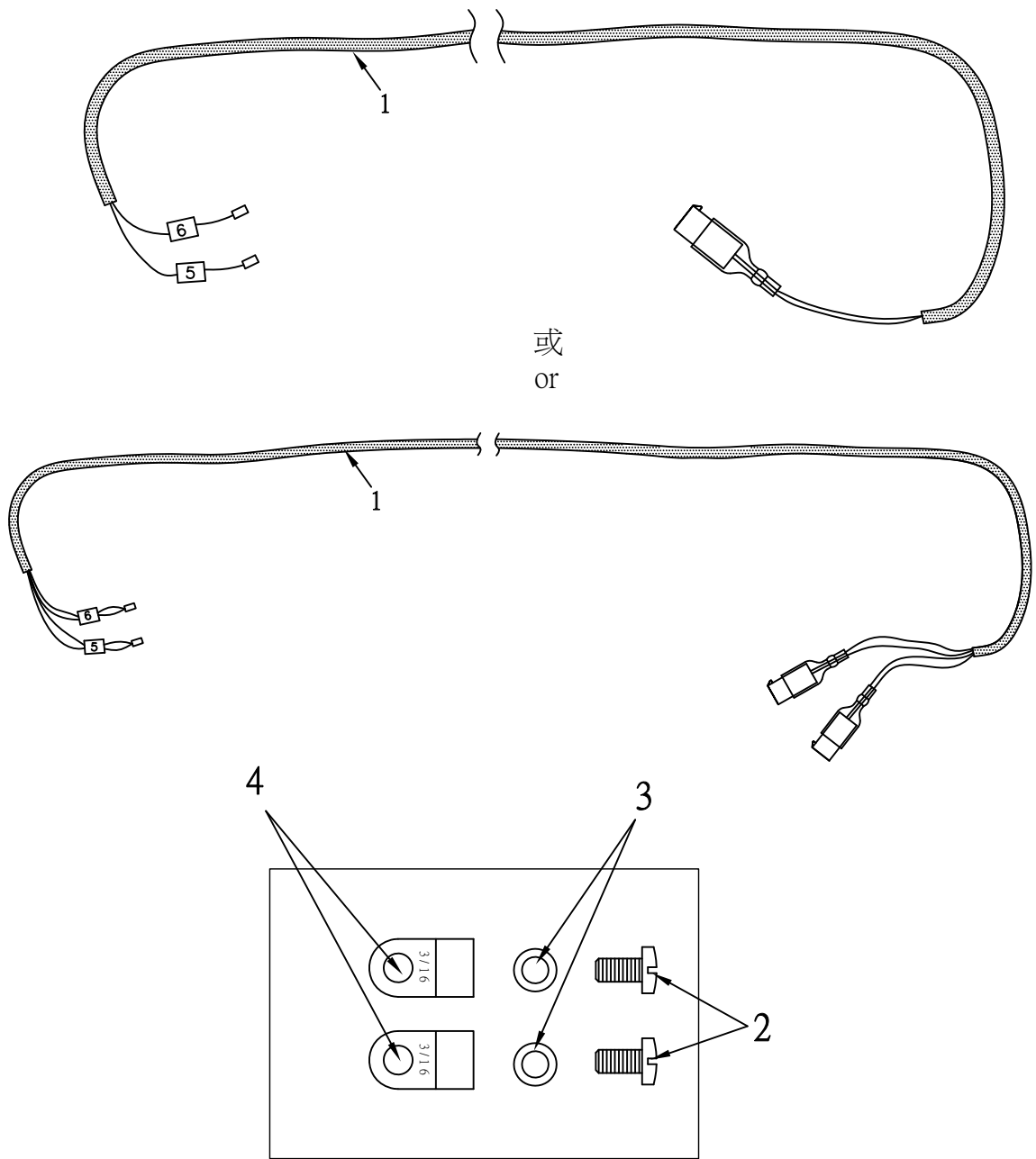

序號 Ref.No.	物料編號 Part.No.	名稱 Description	單位用量 Amt.Req.
1	DST-2P	DST-2P電線組 DST-2P Electric wire set	1
	DST-4P	DST-4P電線組 DST-4P Electric wire set	1
2	SW0306	一字平頭螺絲 Flat heat slot screw	2
3	SW0702	墊片 Washer	2
4	BFIX-005	3 / 16固定鈕 3/16 Thread lock(Fixed ring)	2