

※請仔細閱讀此說明書，以確保您可以在最短時間內完成安裝。  
Please read this instruction carefully to ensure the installation is completed.

# WP

## 安裝說明書

### Installation Introduction

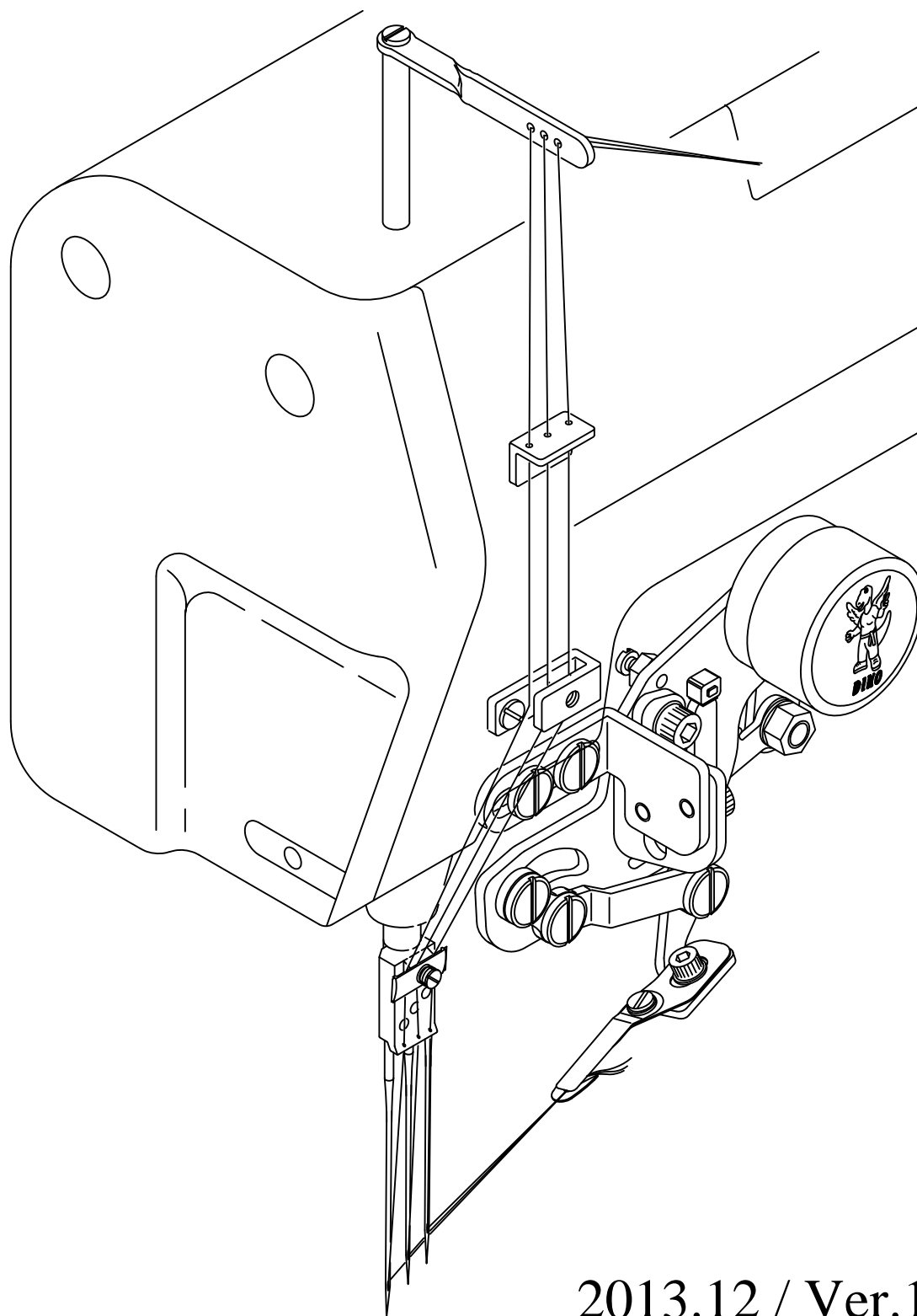

2013.12 / Ver.1.00

## 前言 PREFACE:

- 請依本說明書頁次按照順序安裝與調整，以確保您可以在最短時間內得到最佳運轉效果。
- Please read the instruction carefully to ensure the installation complete in short time.

### (一)安裝勾線組 WP Wiper mechanism wire hook device

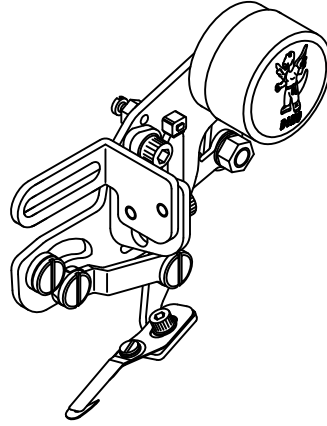

### (二)DST-2P電線組安裝圖 Installation description for DST 2P

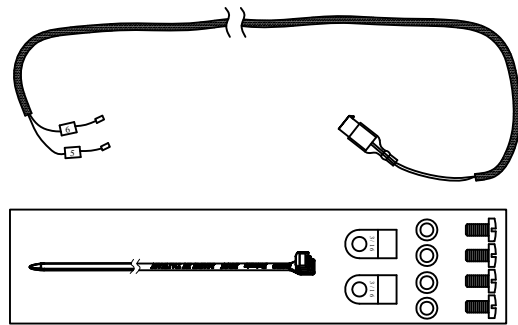

## (一) 安裝勾線裝置WP (Wire hook device)

● 包裝盒內位置標示 The position in the box

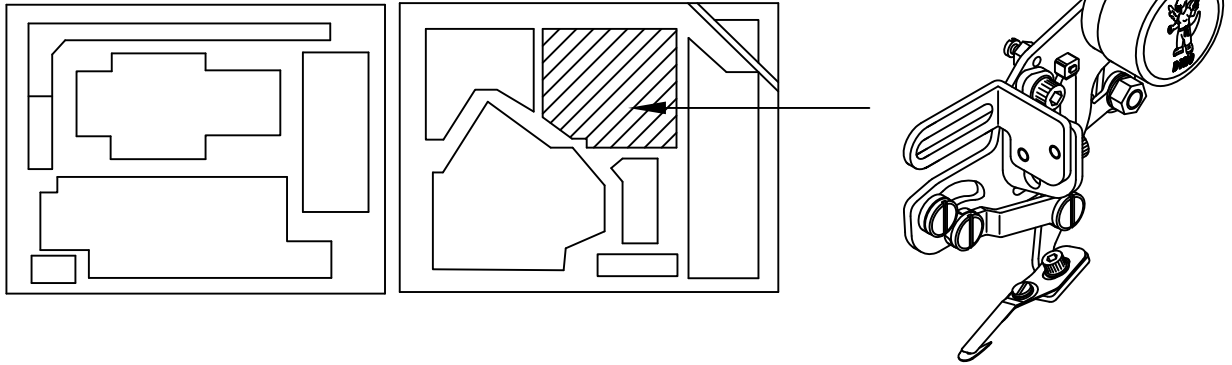

● 安裝位置示意圖 Installation description chart.

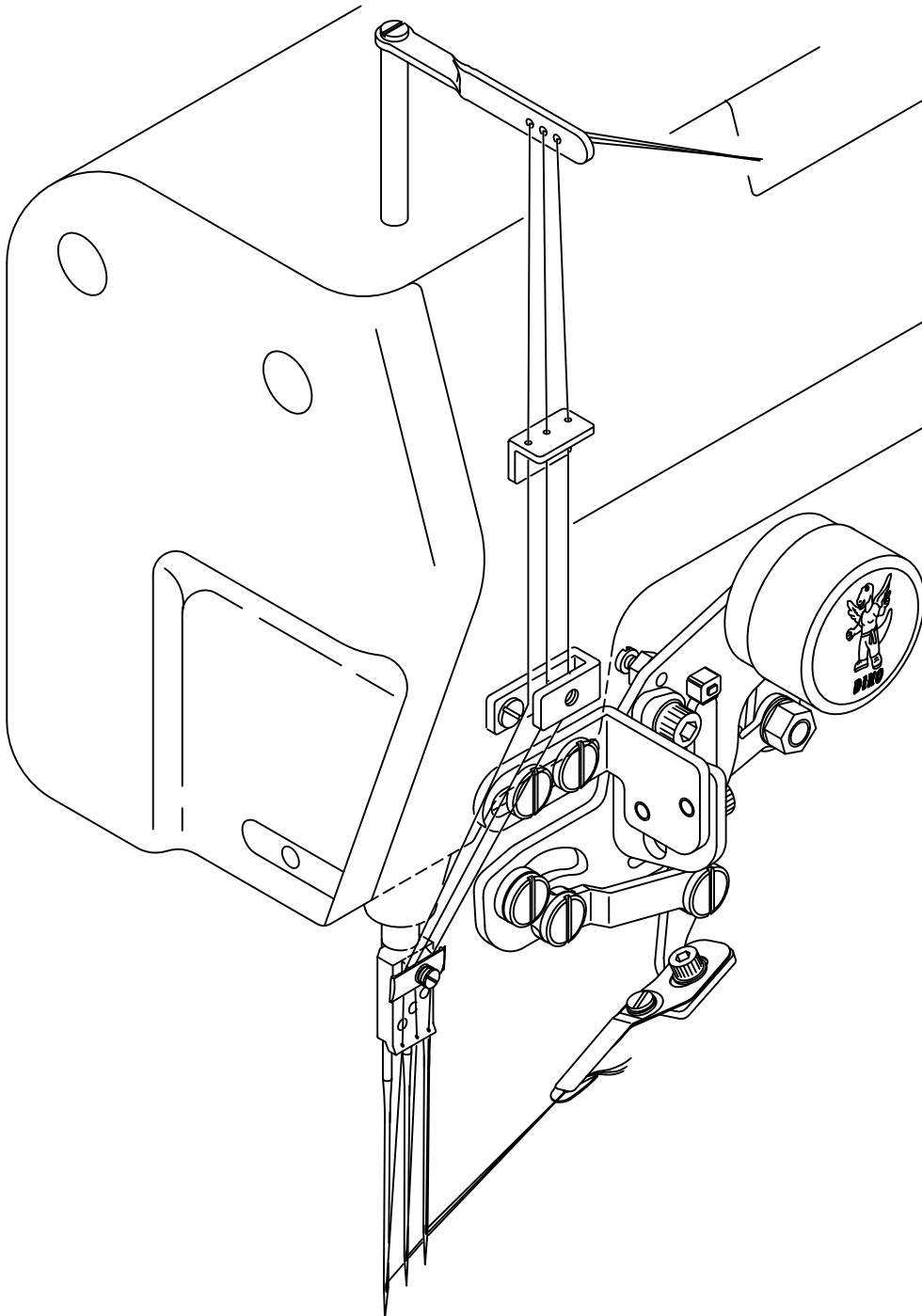

## 請依下列步驟安裝 Please follow the installation step

### (A) 取下原有配件並裝上勾線裝置

Take off the origin factory accessories and install the wire hook device

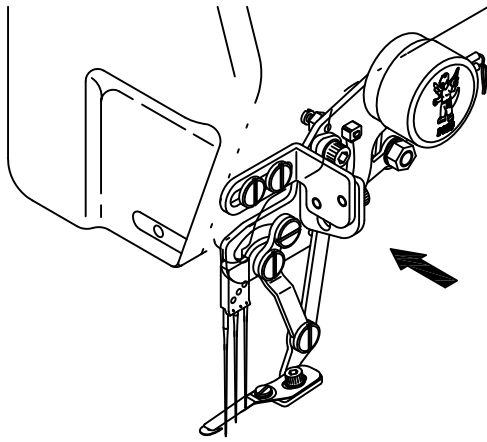

### (B) 旋轉圓軸對準P點

Swirel the rotatory button on the point P

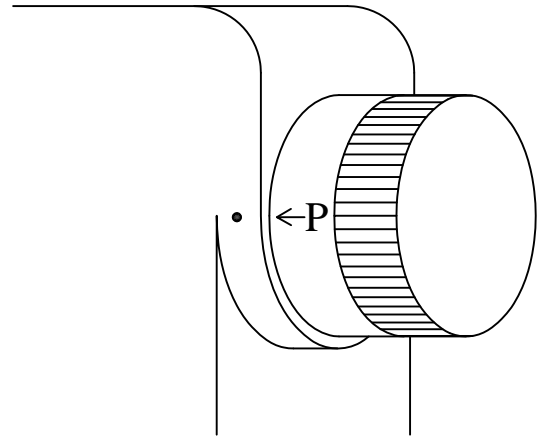

### (C) 1. 鬆開螺絲

2. 將勾針推到底

3. 左右移動裝置調整勾針與第一根針頭距離約2~3mm

4. 鎖緊螺絲

1. Loosen the screw.

2. Push the wire hook reed down.

3. Move and adjust the wire hook reed and keep the distance about 2~3mm between the first syringe needle.

4. Fasten the screw.

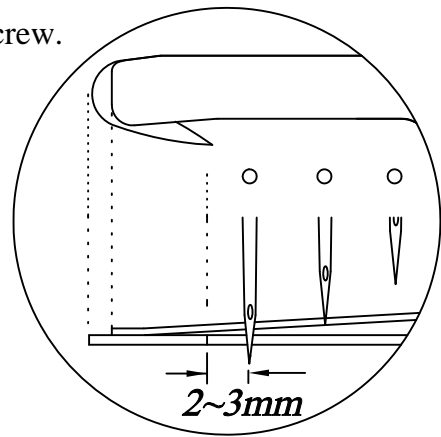
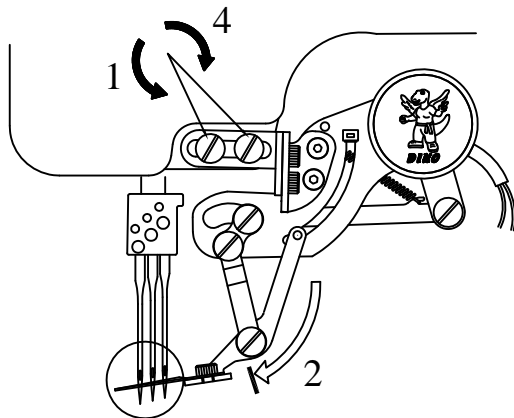

### (D) 調整螺絲高度以控制:

1. 勾針底部與針頭底部距離約1~2mm

2. 勾針側面與針邊距離約0.3mm

3. 放鬆螺絲，調整角度。

Adjust the screw attitude to control the following:

1. Keep the distance about 1~2mm between the lower part of wire hook reed and the topper part of syringe needle .

2. Keep the distance about 0.3mm between the side of wire hook reed and the syringe needle.

3. Relax the screw, adjust the angle.

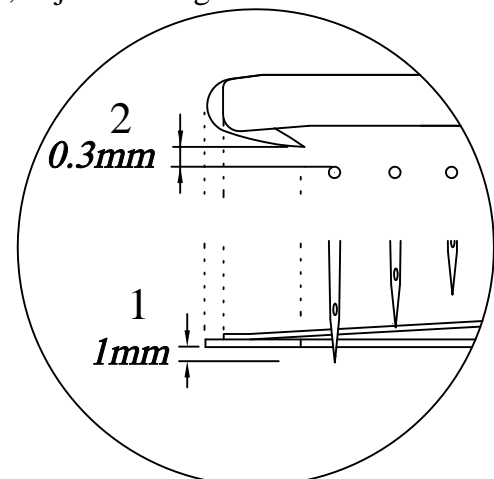
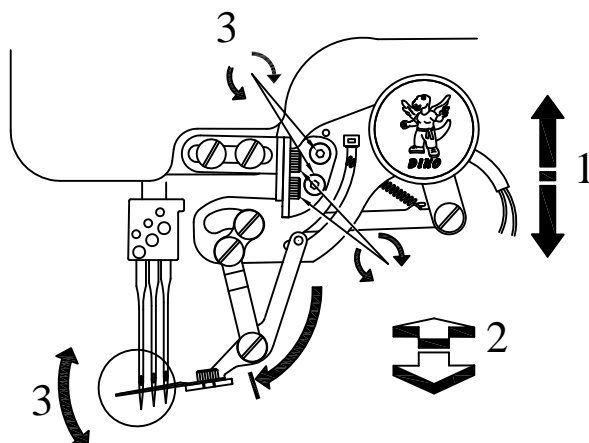

## (二) DST-2P電線組安裝圖 Installation description for DST 2P

◎包裝盒內位置標示 The position in the box

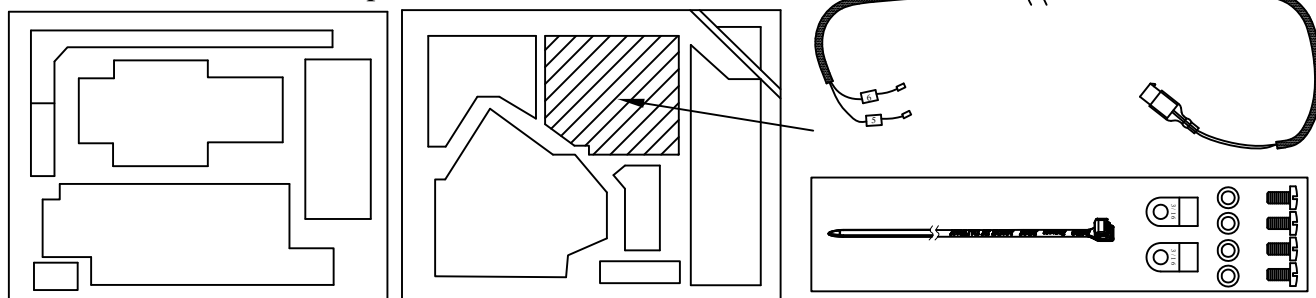

◎安裝位置示意圖 Installation description chart.

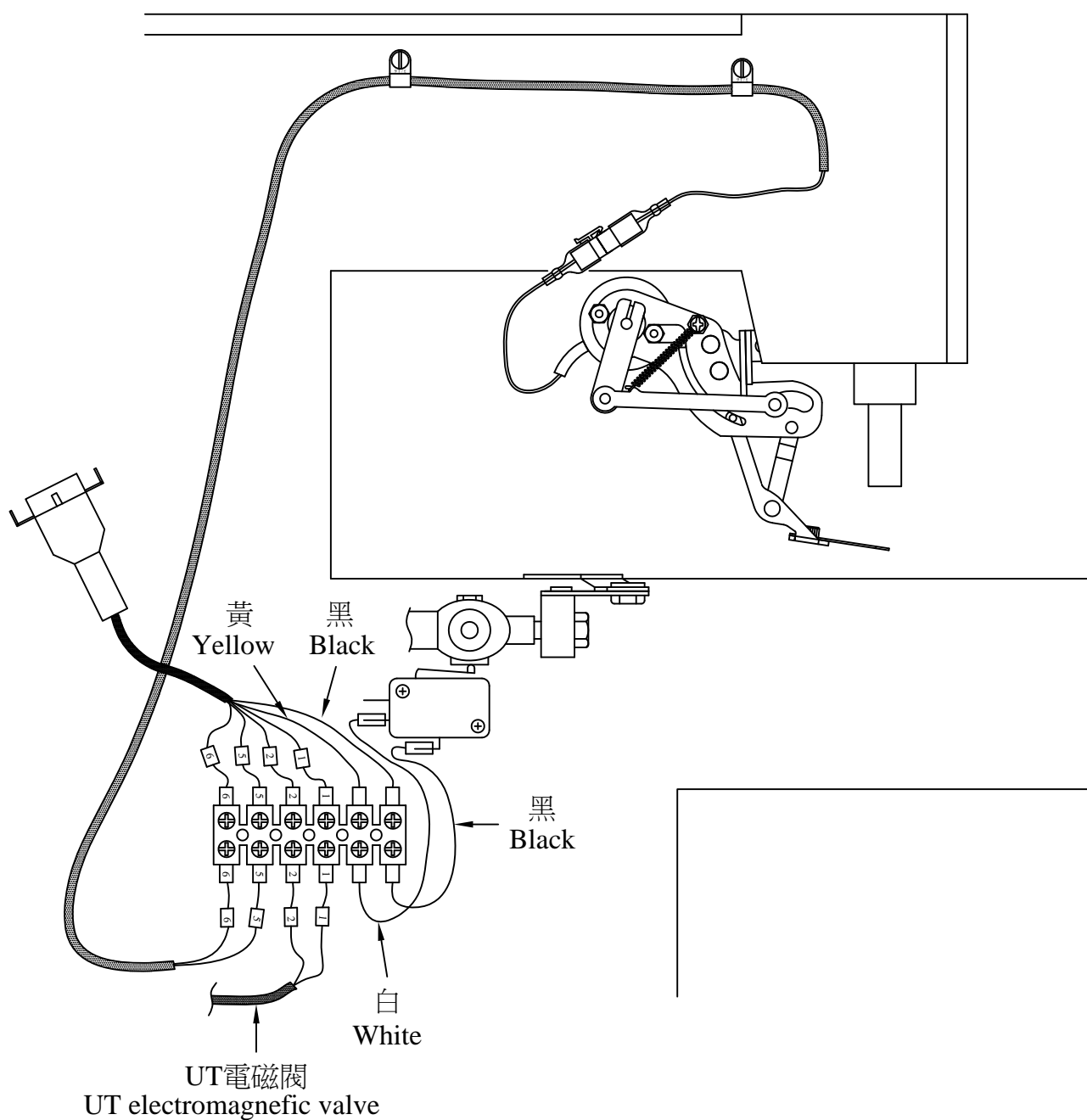

# WP-勾線裝置機構零件分析圖

## WP-Wire hook device

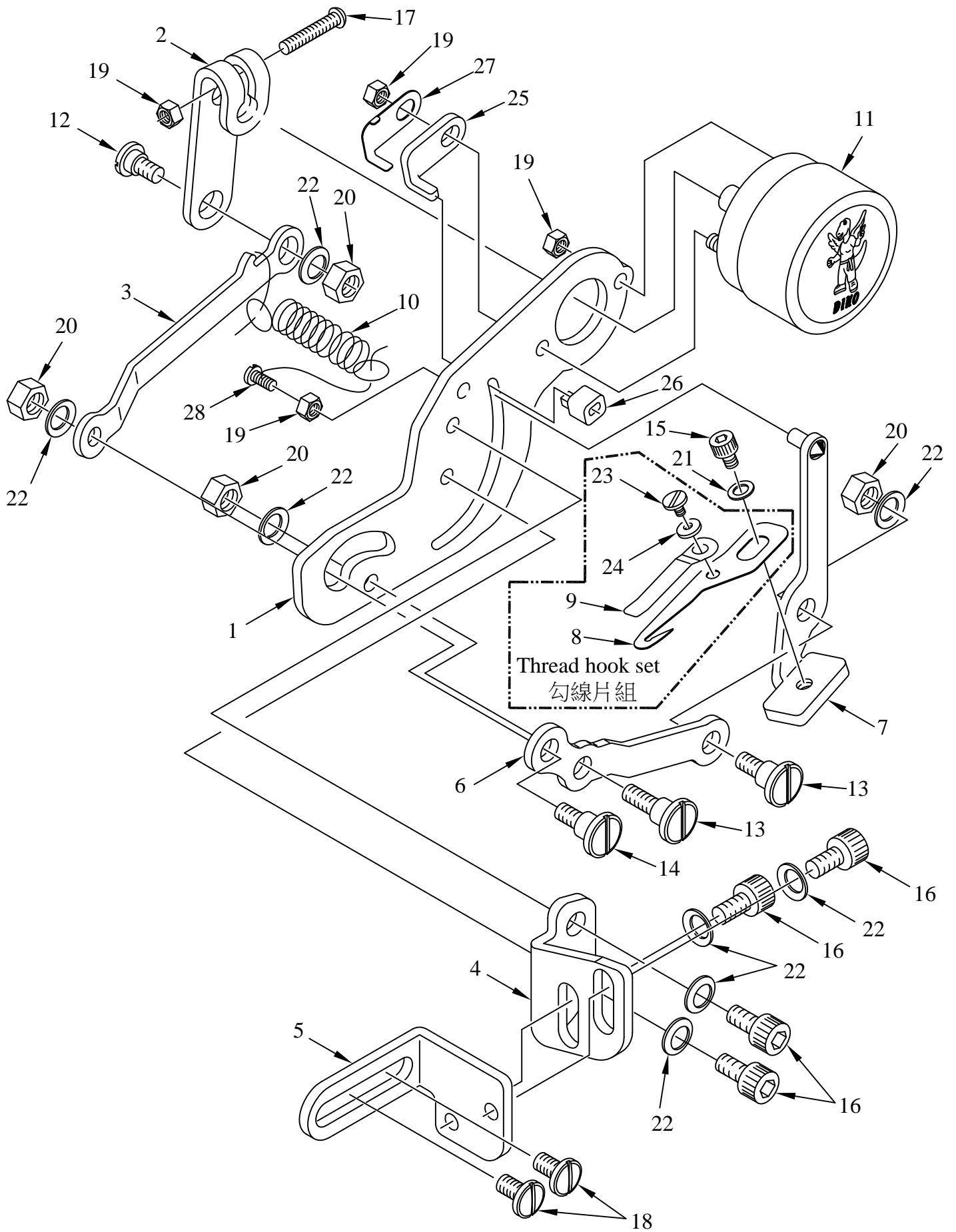

## WP-勾線裝置機構零件分析表

## WP-Wire hook device

序 號 Ref.No.	物料編號 Part.No.	名 稱 Description	單位用量 Amt.Req.
1	WP-01	本體 Main plate	1
2	WP-02	連桿 Coupling rod	1
3	WP-03	拉桿 Pull bar	1
4	WP-04	調整座 Adjustment seat	1
5	WP-05	定位座 Fixing seat	1
6	WP-06	擺臂 Swing shaft	1
7	WP-07	勾線簧片固定座 Wire hook reed fixing seat	1
8	WP-08	勾線片 Wire hook	1
9	WP-09	勾線簧片 Wire hook reed	1
10	WP-10	拉伸彈簧 Extension spring	1
11	DST-01	電磁閥 Electromagnetic valve	1
12	CB003-3	特製螺絲 Special screw	1
13	W612-A	特製螺絲 Special screw	2
14	W613	特製螺絲 Special screw	1
15	SW0101	六角承窩螺絲 Hexagon socket screw	M3x3 1
16	SW0104	六角承窩螺絲 Hexagon socket screw	M4x6 4
17	SW0201A	六角半圓螺絲 Semicircle screw	M3x14 1
18	SW0306	一字平頭螺絲 Flat head slot screw	M4x8 2
19	SW0601	六角螺帽 Hexagon nut	M3 4
20	SW0602	六角螺帽 Hexagon nut	M4 4
21	SW0701	盤形墊圈 Dish washer	M3 1
22	SW0702	盤形墊圈 Dish washer	M4 8
23	SW0801	一字平頭螺絲 Flat head slot screw	3/32-56x2 1
24	SW0713	墊圈 Washer	M2 1
25	WP-11	行程擋塊 Position curved kit	1
26	WP-12	橡膠套 Rubber bush	1
27	WP-13	保護片 Protect plate	1
28	SW1001	十字平頭螺絲 Crossed flat head screw	M3x6 1
PS.勾線片組為8.9.23.24號零件各一件 PS.8.9.23.24 are park of thread hook set.			

# DST-2P

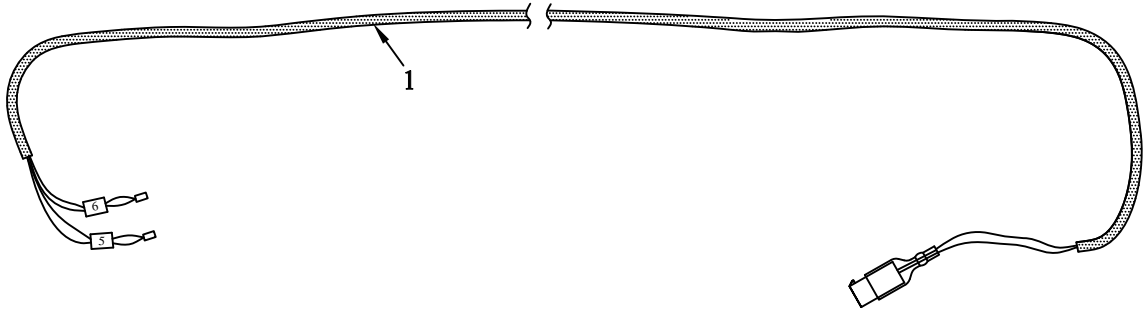

序 號 Ref.No.	物料編號 Part.No.	名 稱 Description	單位用量 Amt.Req.
1	DST-2P	DST-2P電線組 DST-2P electric wire set	1