

TK-A

安裝說明書

Installation Introduction

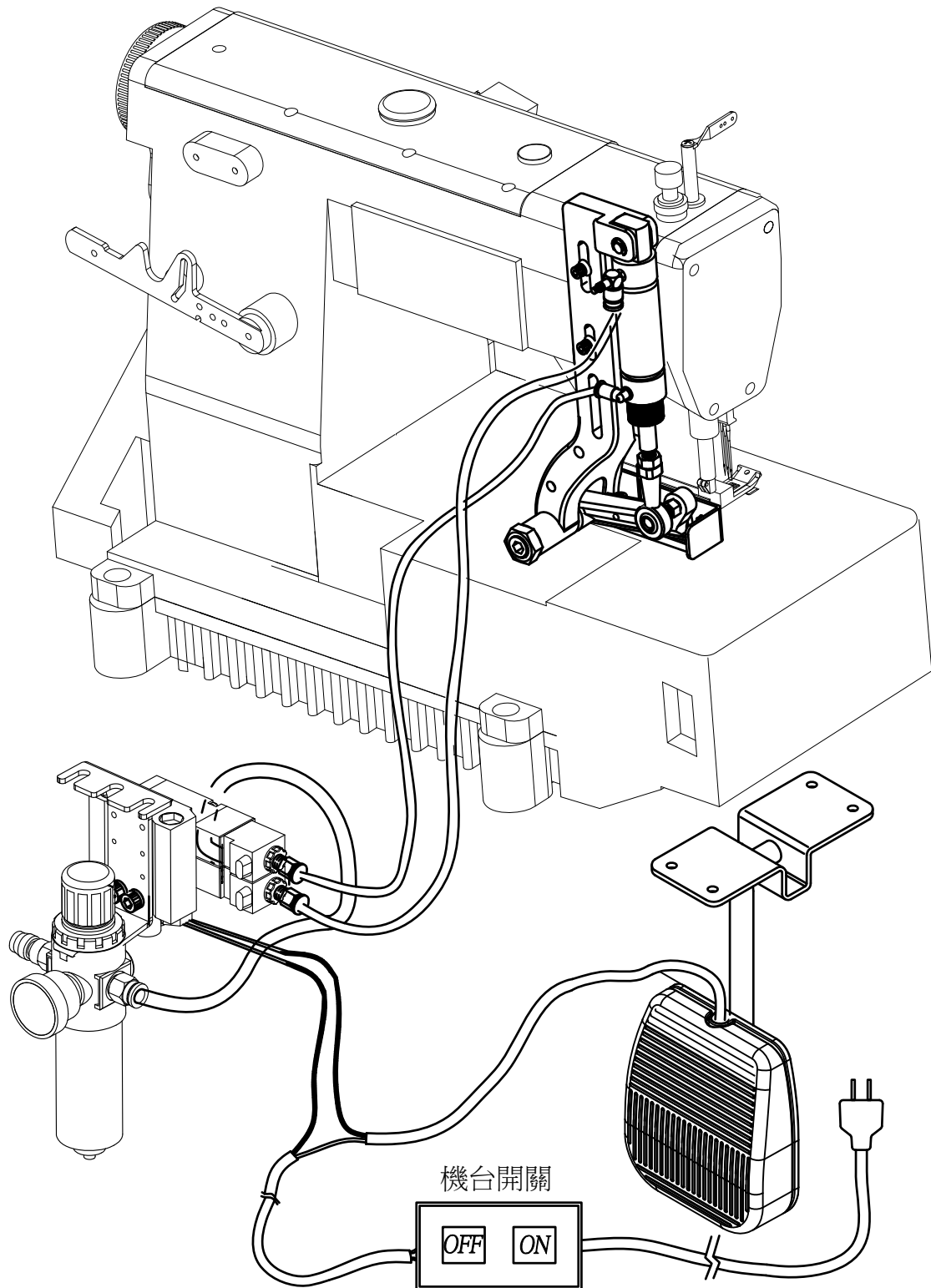

2015/04

●安裝位置示意圖 Installation description chart.

1.裝上TK斬刀

Install TK

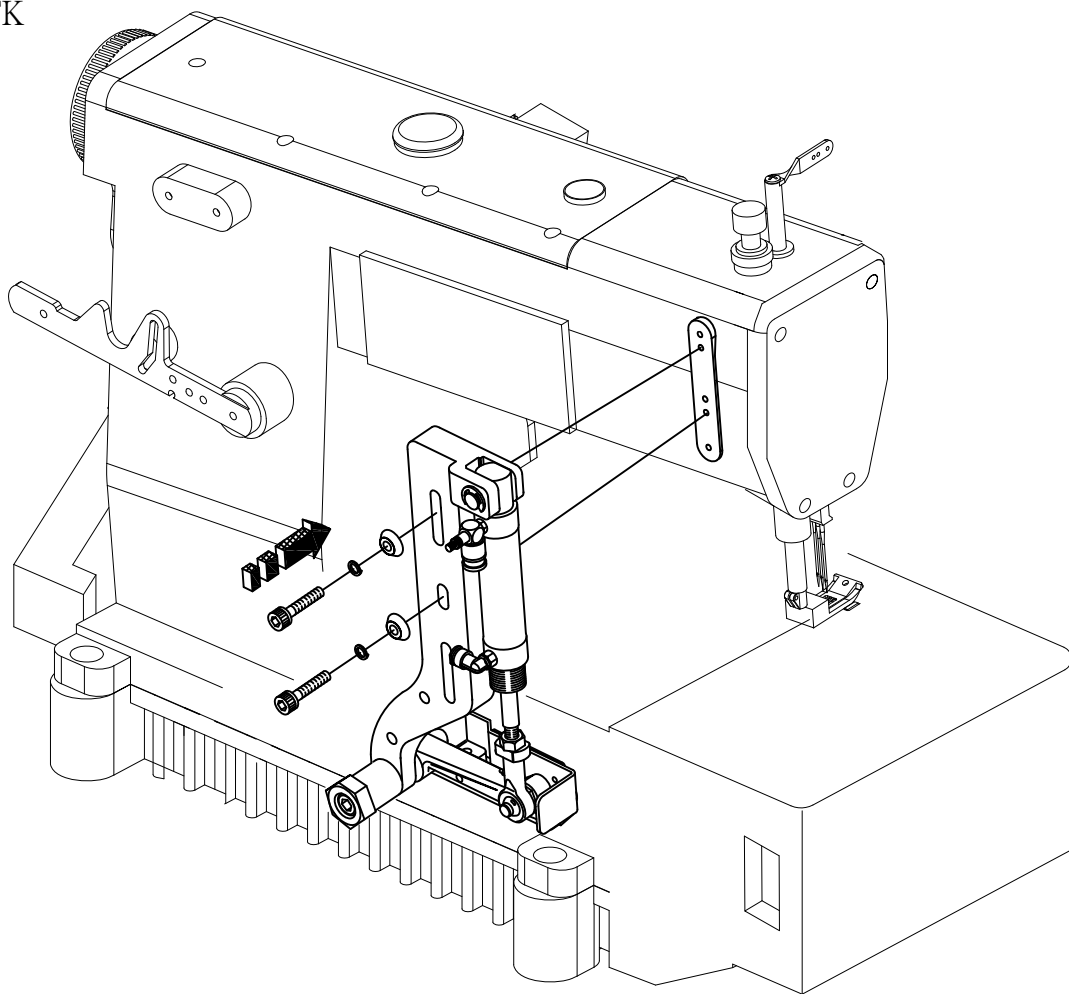

2.下刀與機台面需一端貼合,另一端浮起約0.5-1mm

One end of under-knife stick on tabletop, the other end float 0.5~1mm from tabletop.

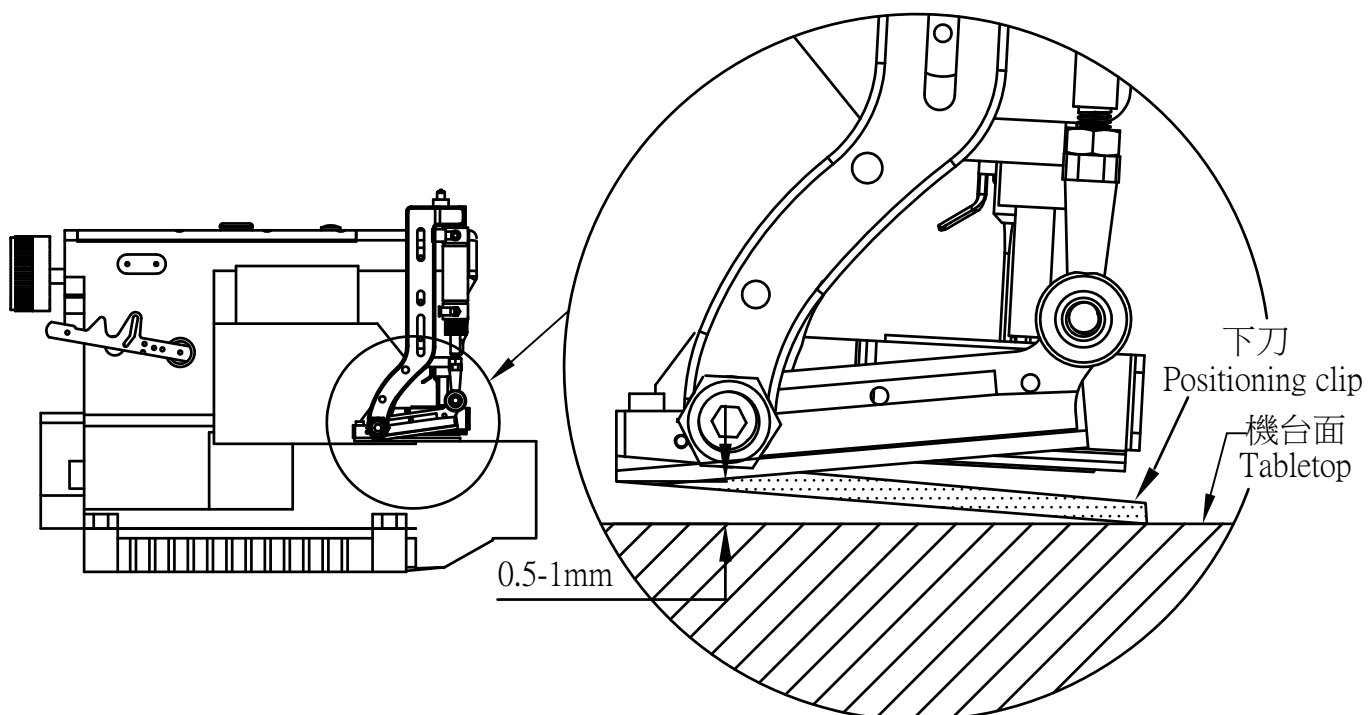

3、汽缸氣壓管連接圖與電路配置圖
The instruction for connect tube.

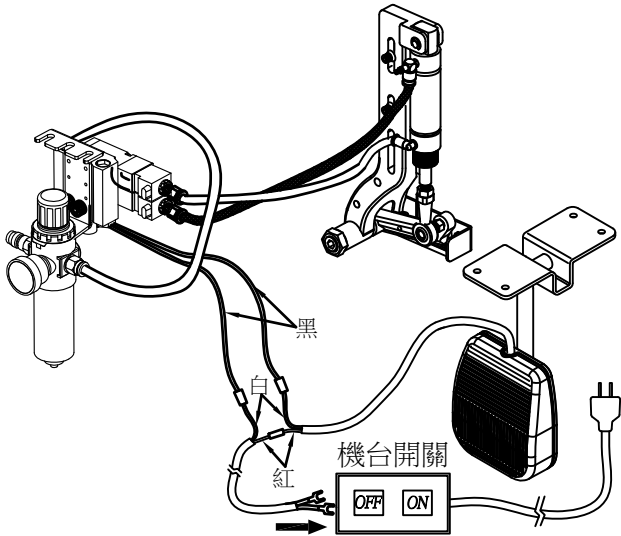

4、安裝氣動組 Installation of pneumatic set.
(A).將氣動組裝上後，向左方調整，再將螺絲鎖緊。
After installs pneumatic set please adjust it towards left side then fasten screw.

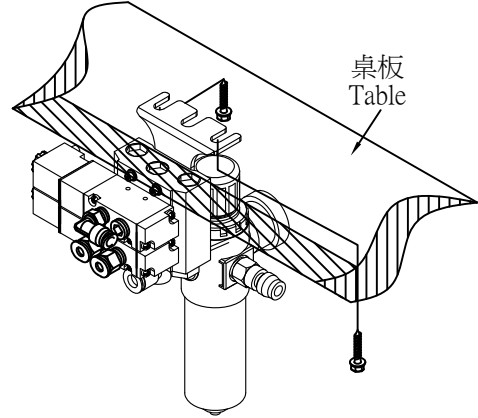

(C).完成如圖。
Accomplish as below picture.

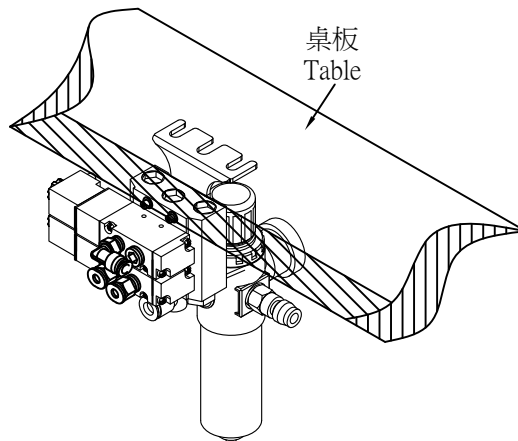

●安裝位置示意圖
Installation description chart.

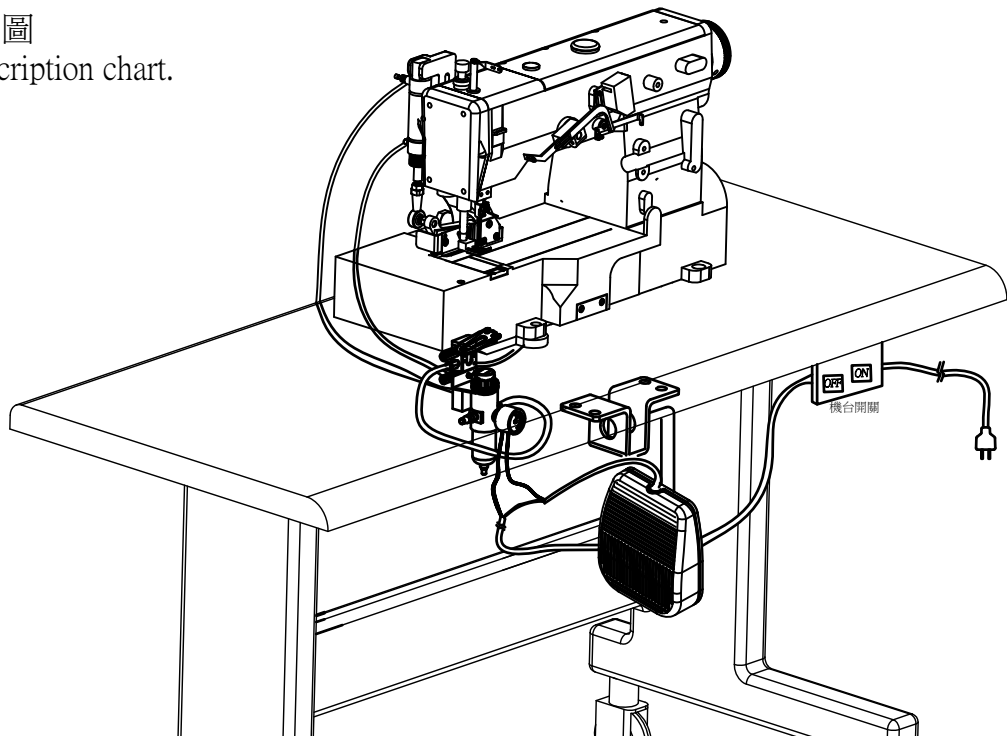

TK-分析圖

TK-Detail drawing

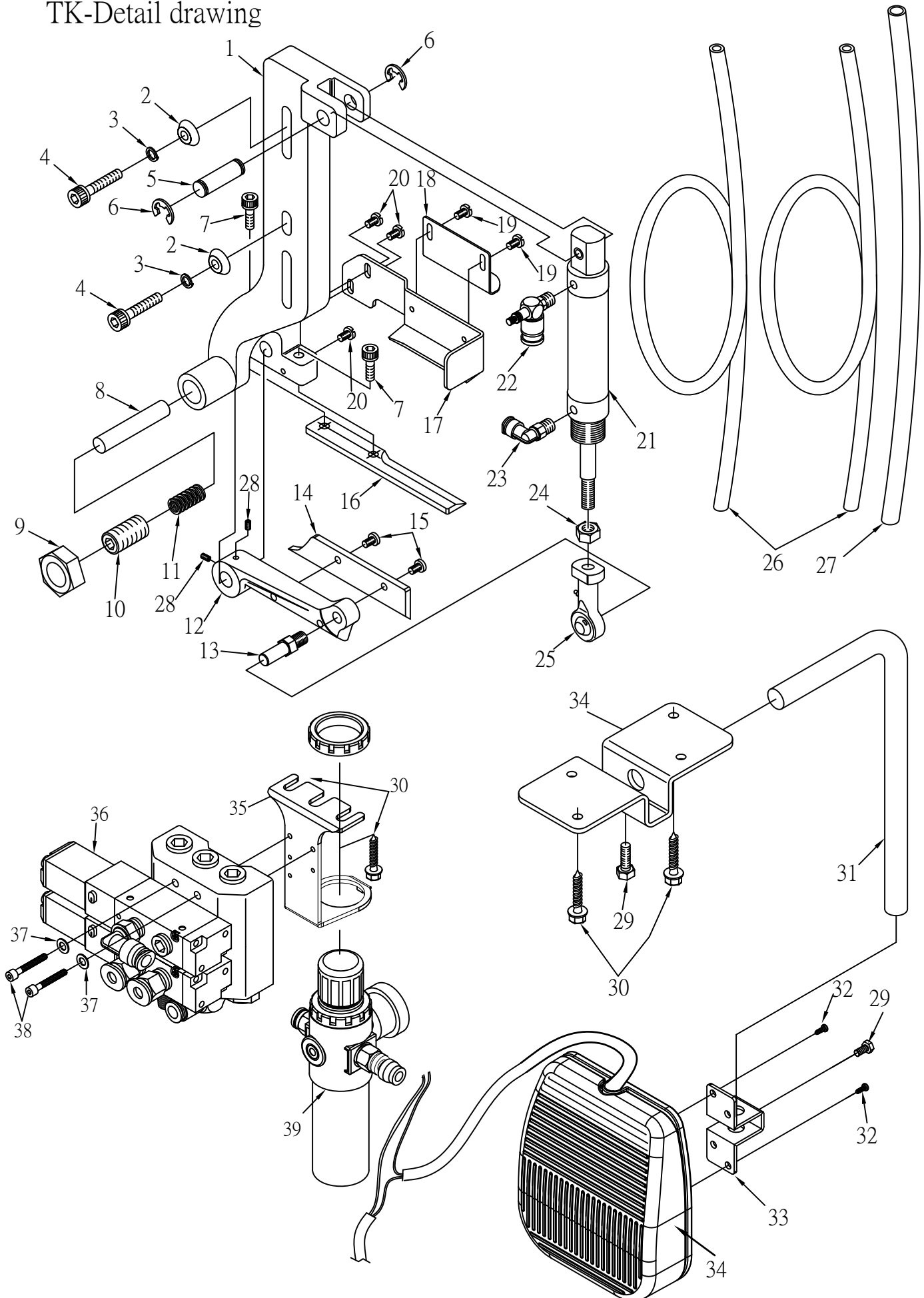

TK-零件分析表

TK-Detail drawing

序號 Ref.No.	物料編號 Part.No.	名稱 Description	單位用量 Amt.Req.
1	TKA-01	本體 Main plate	1
2	SW0714	錐型墊片 Taper washer M6	2
3	SW0711-A	彈簧墊片 Spring Washer SM6(黑)	2
4	SW0136	六角承窩螺絲 Hexagon socket screw M6x25L	2
5	TKA-02	軸 Axle	1
6	E-7	E型扣環 E shape retaining $\phi 7$	2
7	SW0124	六角承窩螺絲 Hexagon socket screw M5x16L	2
8	TK-02-1	軸 Axle	1
9	TK-12	六角螺帽 Hexagon nut M14	1
10	SW0512	無頭承窩螺絲 Headless socket screw M14x14L	1
11	TK-01	彈簧 Spring	1
12	TKA-03	上刀座 Upper knife seat	1
13	TKA-04	軸心 Square connection slice	1
14	TK-03	上刀 Upper knife	1
15	SW0204	六角半圓頭螺絲 Shaft M5x8L	1
16	TK-04	下刀 Under Knife	1
17	TK-05	保護片 Protector piece	1
18	TK-06	保護片 Protector piece	1
19	SW0303	一字平頭螺絲 Minus flat head screw M4x5L	2
20	SW0305	一字平頭螺絲 Minus flat head screw M4x7L	3
21	TKA-05	傳動汽缸 Cylinder	1
22	VG2700A-DVC14	氣閘軟管接頭 Air brake hose coupling	1
23	VG2700A-DVC07	空氣管接頭 Connector	2
24	SW0605	六角螺帽 Hexagon nut M8	1
25	VC2700E-UTE02	連桿端軸承 Coupling rod end bearing	1
26	Tube-02-1240	氣閘軟管 Air brake hose $\phi 6x \phi 4$	2
27	Tube-03-600	氣閘軟管 Air brake hose $\phi 8x \phi 5$	1
28	SW0505	無頭螺絲 Headless socket screw M5x5L	2
29	SW1009	外六角螺絲 Hexagon screw M5x10L	2
30	SW0909	六角頭木螺釘 Wooden screw -	4
31	TK-08	軸 Axle	1
32	SW0940	十字頭木螺釘 Crossed wooden screw M3.5X11	2
33	LFE-15	腳踏開關座(二) Pedal switch seat(II)	2
34	PS-A	腳踏開關 Pedal switch	1
35	VG2700A-DVC39-A	固定座 Fixed seat -	1
36	VG2700A-DVCA	電磁鐵 Electromagnetic valve	2
37	SW0702	盤型墊片 Washer M4	2
38	SW0111	內六角螺絲 Crossed flat head screw M4x30	2
39	VG2700A-DVC13-3	空壓瓶 Compressed air bottle -	1

贈品使用方法：
How to use the gift：
1、重複環保萬用繩
Reusable eco-friendly universal tie

小心刺傷眼睛！
Caution for eye injuries！

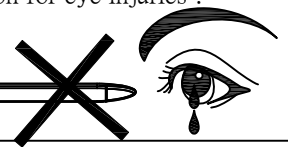

使用方法：
How to use：

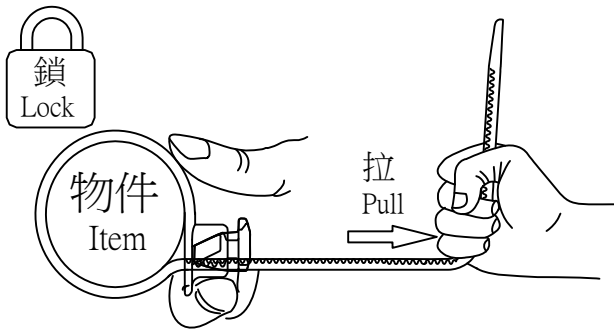

A 將萬用繩尾端往後拉緊即可。
Pull the strap to fasten.

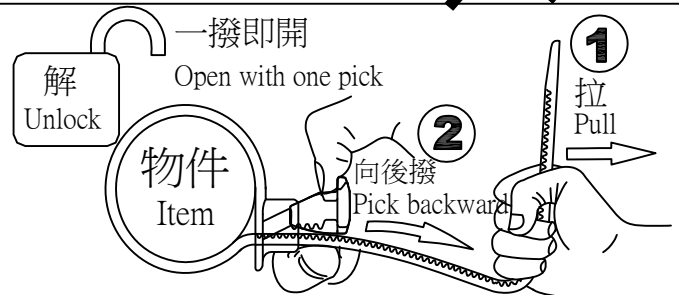

B-1 將萬用繩尾端往後拉，一撥即開。
Pull the universal tie backward and pick to open

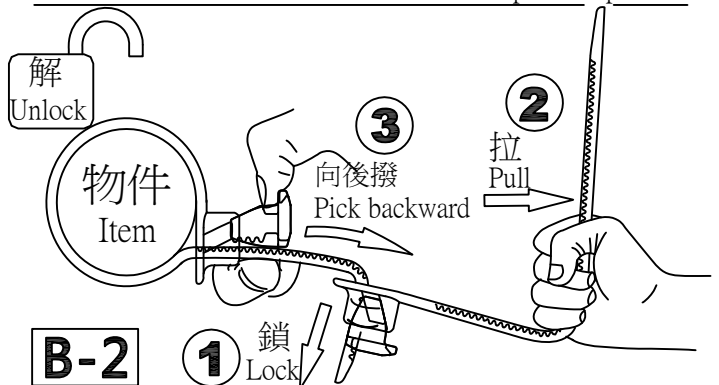

B-2 若尾端太短，可先將一根萬用繩連接在原萬用繩尾端，再往後拉，一撥即開。
If its too short to open, connect another piece of universal tie to make it longer and follow the same step as above.

2、磨剪刀器使用方法：如圖面來回磨擦數次即可。
How to use Scissors sharpener : Rubbing back and forth several times as figures.

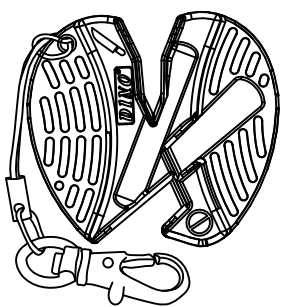

請注意正確的握姿：磨刀時手嚴禁握在磨刀口的正下方！
Carefully use with correct position : Strictly forbid to hold under the sharpener !

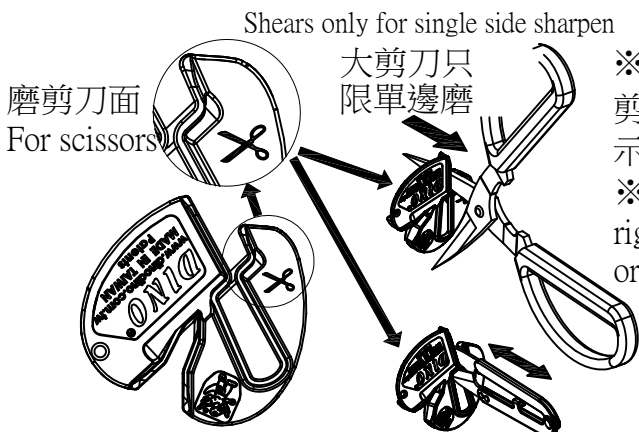
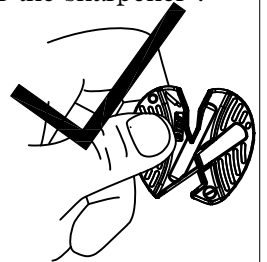
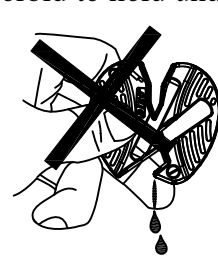
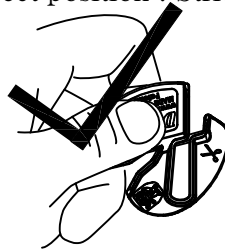
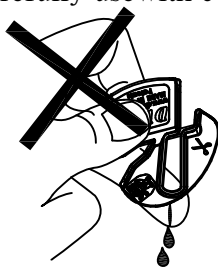

※請使用正確的磨剪刀面，剪刀圖示面為磨剪刀面。
※Please choose the rightside for scissors or knives as the signal.

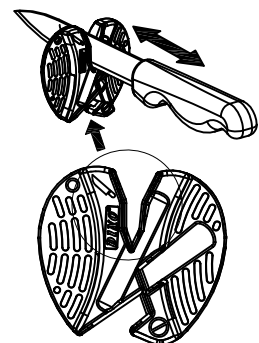

"V"型槽為磨直刀口，兩面皆可磨。
Bothside "V" notch is for knives.